









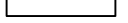
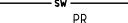

LEGEND

-  END STRUCTURE
-  LIP-IN-LINE GULLY PIT
-  ANTI-PONDING PIT
-  MAINTENANCE HOLE
-  EXTENDED MAINTENANCE HOLE
-  SEDIMENT FOREBAY
-  DRAINAGE PIPE
-  PRAM RAMP
-  TRAFFIC SIGN
-  EDGE OF PATHWAY
-  EDGE OF PAVEMENT
-  BARRIER KERB AND CHANNEL - B1 (IPWEAQ RS-080)
-  MOUNTABLE KERB AND CHANNEL - M3 (IPWEAQ RS-080)

REGISTERED SURVEYOR'S CERTIFICATION

I, _____ hereby certify that the vertical and horizontal locations and dimensions shown on this plan are a true and correct record and were located by survey.

Registered Surveyor (sig.) _____ Reg. Surveyor No. _____ Date: _____

AS CONSTRUCTED CERTIFICATION

I, _____ (Company's representative Name) _____ (Signature)

(Date) _____ (RPEQI) _____

Being a duly representative of- _____ (Company Name)

Hereby certify that:

- The information contained in this drawing / document is in compliance with approved drawings and design supplied under the terms of the contract.
- This represents an accurate "As constructed" record of works carried out and accept responsibility for the information contained in this drawing / document.

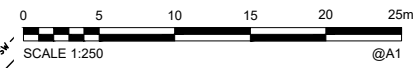
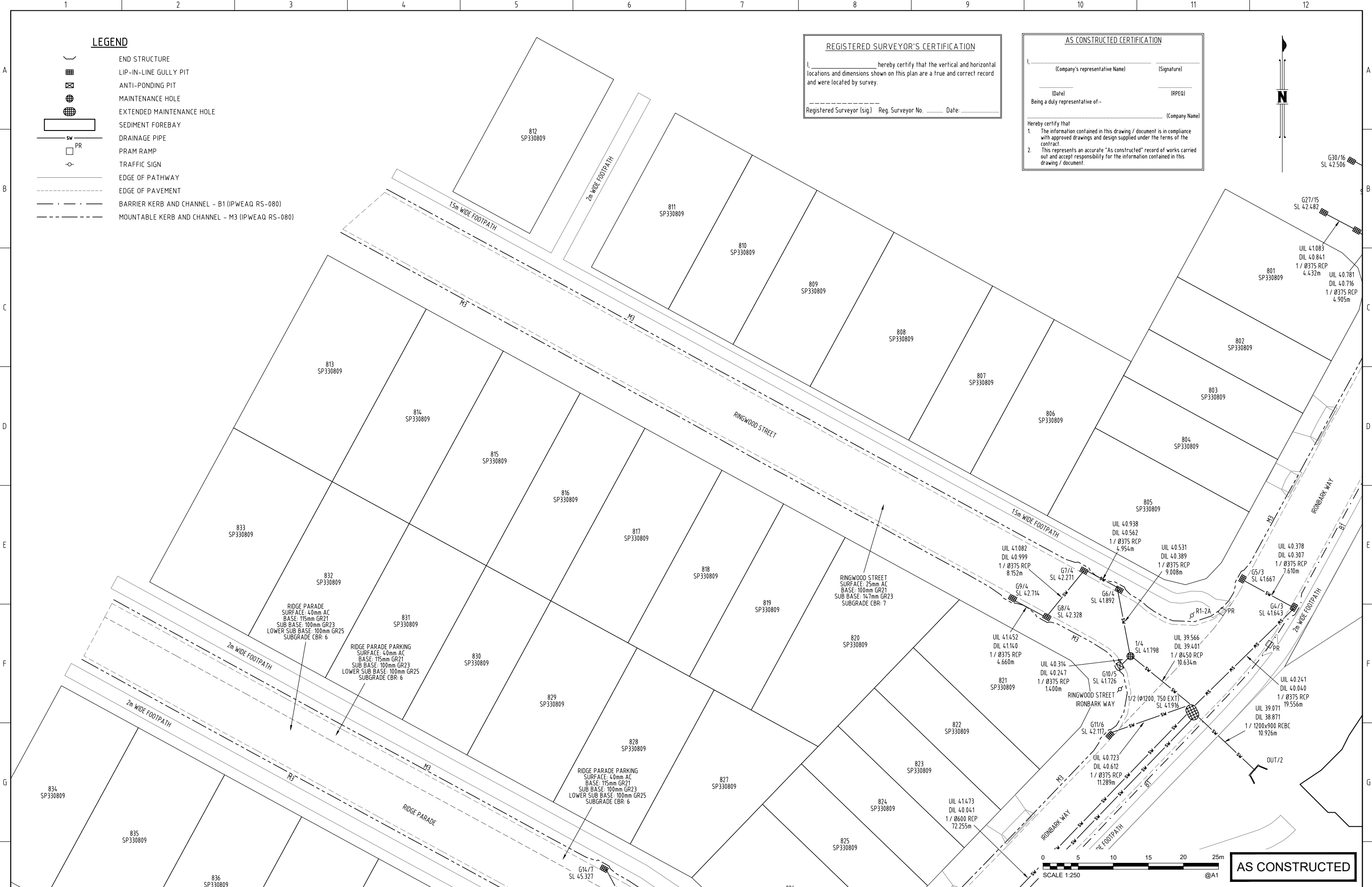

AS CONSTRUCTED

DRAWING REVISIONS		REFERENCE DRAWINGS		DESIGN FILE No.	DESIGNED
REV.	REVISION DESCRIPTION	DRG. No.	DESCRIPTION	CONSTRUCT. No.	DATE
0	AS-CONSTRUCTED DRAWINGS				

DESIGNED	CHECKED	DATE
BR	LG	05/09/2023

THIS WORK WAS PREPARED BY:

Lion Systems on behalf of SHADFORTH

SCALE 1:250 ORIGINAL SIZE A1



MORETON BAY REGIONAL COUNCIL
 PINE DISTRICT OFFICE
 220 GYMPIE ROAD STRATHPINE QLD 4500
 PO BOX 159 CABOOLTURE QLD 4510
 Telephone: (07) 3480 8666
 Fax: (07) 3480 8710

**ROADS AND DRAINAGE
 AS CONSTRUCTED
 RIDGEVIEW - STAGE 8
 RAYNBIRD ROAD, NARANGBA**

MBRC SUBDIVISION REFERENCE	
DA/2022/2243	
No. 1 OF 3 PLANS	
ASCON GRID NUMBER	REV.
	0

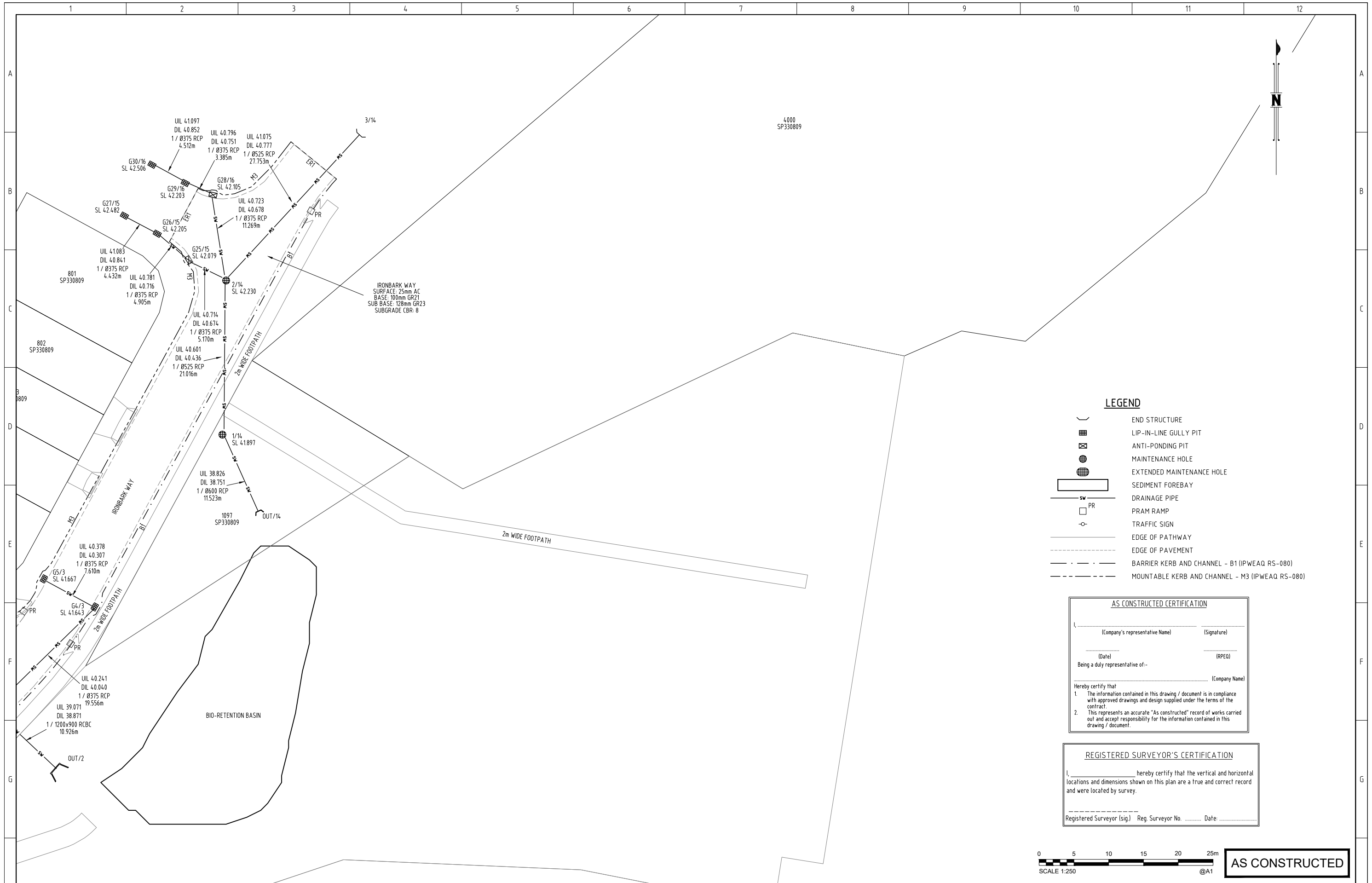

LEGEND

	END STRUCTURE
	LIP-IN-LINE GULLY PIT
	ANTI-PONDING PIT
	MAINTENANCE HOLE
	EXTENDED MAINTENANCE HOLE
	SEDIMENT FOREBAY
	DRAINAGE PIPE
	PRAM RAMP
	TRAFFIC SIGN
	EDGE OF PATHWAY
	EDGE OF PAVEMENT
	BARRIER KERB AND CHANNEL - B1 (IPWEAQ RS-080)
	MOUNTABLE KERB AND CHANNEL - M3 (IPWEAQ RS-080)

AS CONSTRUCTED CERTIFICATION

I, _____
 (Company's representative Name) (Signature)

_____ (Date) _____ (RPEQ)

Being a duly representative of: _____ (Company Name)

Hereby certify that

- The information contained in this drawing / document is in compliance with approved drawings and design supplied under the terms of the contract.
- This represents an accurate "As Constructed" record of works carried out and accept responsibility for the information contained in this drawing / document.

REGISTERED SURVEYOR'S CERTIFICATION

I, _____ hereby certify that the vertical and horizontal locations and dimensions shown on this plan are a true and correct record and were located by survey.

Registered Surveyor (sig.) Reg. Surveyor No. _____ Date: _____

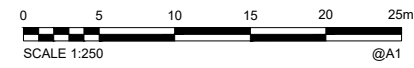

AS CONSTRUCTED

DRAWING REVISIONS		REFERENCE DRAWINGS		DESIGN FILE No.	DESIGNED
REV.	REVISION DESCRIPTION	DRG. No.	DESCRIPTION	CONSTRUCT. No.	DATE
0	AS-CONSTRUCTED DRAWINGS				
				SURVEY FILE No.	DRAWN BR
				FIELD BOOK	DATE 05/09/2023
				LOG BOOK	CHECKED LG
				LEVEL DATUM	DATE 05/09/2023
				DATUM	

THIS WORK WAS PREPARED BY:

Lion Systems on behalf of SHADFORTH

SCALE 1:250 ORIGINAL SIZE A1



MORETON BAY REGIONAL COUNCIL
 PINE DISTRICT OFFICE
 220 GYMPIE ROAD STRATHPINE QLD 4500
 PO BOX 159 CABOOLTURE QLD 4510
 Telephone: (07) 3480 6666
 Fax: (07) 3480 6710

ROADS AND DRAINAGE
AS CONSTRUCTED
RIDGEVIEW - STAGE 8
RAYNBIRD ROAD, NARANGBA

MBRC SUBDIVISION REFERENCE	
DA/2022/2243	
No. 2 OF 3 PLANS	
ASCAN GRID NUMBER	REV.
	0

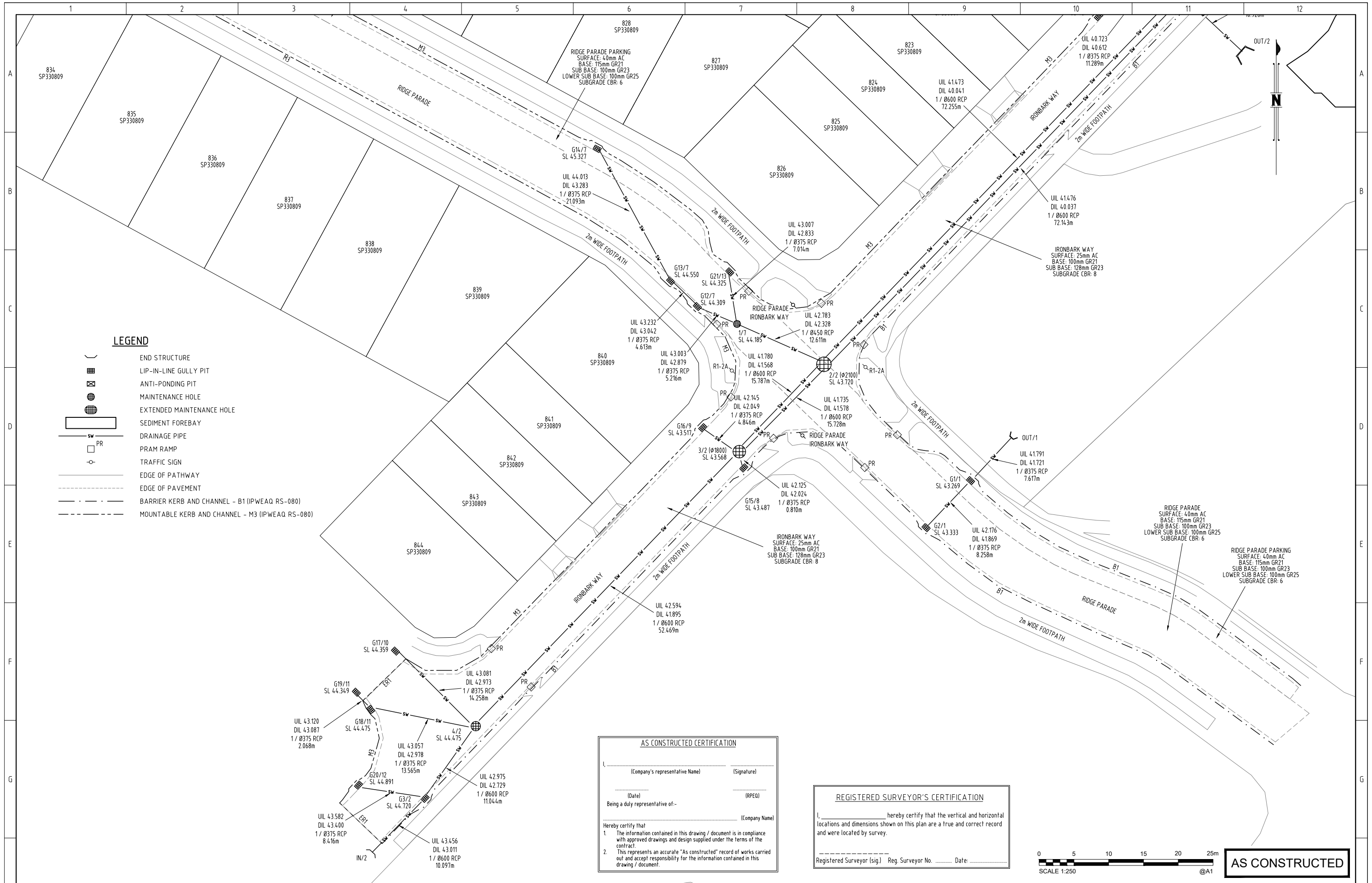

LEGEND

- END STRUCTURE
- LIP-IN-LINE GULLY PIT
- ANTI-PONDING PIT
- MAINTENANCE HOLE
- EXTENDED MAINTENANCE HOLE
- SEDIMENT FOREBAY
- DRAINAGE PIPE
- PRAM RAMP
- TRAFFIC SIGN
- EDGE OF PATHWAY
- EDGE OF PAVEMENT
- BARRIER KERB AND CHANNEL - B1 (IPWEAQ RS-080)
- MOUNTABLE KERB AND CHANNEL - M3 (IPWEAQ RS-080)

AS CONSTRUCTED CERTIFICATION

I, _____ (Company's representative Name) _____ (Signature)

_____ (Date) _____ (RPEQ)

Being a duly representative of- _____ (Company Name)

Hereby certify that

- The information contained in this drawing / document is in compliance with approved drawings and design supplied under the terms of the contract.
- This represents an accurate "As Constructed" record of works carried out and accept responsibility for the information contained in this drawing / document.

REGISTERED SURVEYOR'S CERTIFICATION

I, _____ hereby certify that the vertical and horizontal locations and dimensions shown on this plan are a true and correct record and were located by survey.

Registered Surveyor (sig.) Reg. Surveyor No. _____ Date: _____

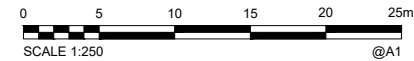

AS CONSTRUCTED

DRAWING REVISIONS		REFERENCE DRAWINGS		DESIGN FILE No.	DESIGNED
REV.	REVISION DESCRIPTION	DRG. No.	DESCRIPTION	CONSTRUCT. No.	DATE
0	AS-CONSTRUCTED DRAWINGS				
				SURVEY FILE No.	DRAWN BR
				FIELD BOOK	DATE 05/09/2023
				LOG BOOK	CHECKED LG
				LEVEL DATUM	DATE 05/09/2023
				DATUM	

THIS WORK WAS PREPARED BY:

Lion Systems on behalf of SHADFORTH

SCALE 1:250 ORIGINAL SIZE A1



MORETON BAY REGIONAL COUNCIL
 PINE DISTRICT OFFICE
 220 GYMPIE ROAD STRATHPINE QLD 4500
 PO BOX 159 CABOOLTURE QLD 4510
 Telephone: (07) 3480 6666
 Fax: (07) 3480 6710

ROADS AND DRAINAGE
AS CONSTRUCTED
RIDGEVIEW - STAGE 8
RAYNBIRD ROAD, NARANGBA

MBRC SUBDIVISION REFERENCE	
DA/2022/2243	
No. 3 OF 3 PLANS	
ASCON GRID NUMBER	REV.
	0