

**REGISTERED SURVEYOR'S CERTIFICATION**

I, \_\_\_\_\_ hereby certify that the vertical and horizontal locations and dimensions shown on this plan are a true and correct record and were located by survey.

Registered Surveyor (sig.) Reg. Surveyor No. \_\_\_\_\_ Date: \_\_\_\_\_

**AS CONSTRUCTED CERTIFICATION**

(Company's representative Name) (Signature)

(Date) (RPED)

Being a duly representative of- (Company Name)

Hereby certify that

- The information contained in this drawing / document is in compliance with approved drawings and design supplied under the terms of the contract.
- This represents an accurate "As constructed" record of works carried out and accept responsibility for the information contained in this drawing / document.

- LEGEND**
- ( ) END STRUCTURE
  - ▣ FIELD INLET
  - ▣ LIP-IN-LINE GULLY PIT
  - ⊕ MAINTENANCE HOLE
  - SW — DRAINAGE PIPE
  - PR PRAM RAMP
  - ⊙ TRAFFIC SIGN
  - EDGE OF PATHWAY
  - - - - - EDGE OF PAVEMENT
  - - - - - BARRIER KERB AND CHANNEL - B1
  - - - - - MOUNTABLE KERB AND CHANNEL - M3
  - FENCING

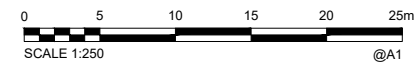
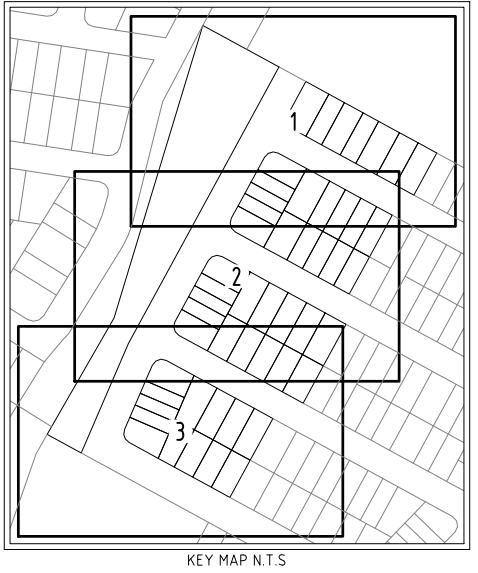

**AS CONSTRUCTED**

DRAWING REVISIONS		REFERENCE DRAWINGS		DESIGN FILE No.		DESIGNED	
REV.	REVISION DESCRIPTION	DRG. No.	DESCRIPTION	CONSTRUCT. No.	SURVEY FILE No.	DATE	
0	AS-CONSTRUCTED DRAWINGS						
					FIELD BOOK	DATE	BAS
					LOG BOOK	CHECKED	DL
					LEVEL DATUM	DATE	17/01/2024
					DATUM		

**THIS WORK WAS PREPARED BY:**

Lion Systems on behalf of SHADFORTH

SCALE 1:250 ORIGINAL SIZE A1



**MORETON BAY REGIONAL COUNCIL**  
 PINE DISTRICT OFFICE  
 220 GYMPIE ROAD STRATHPINE QLD 4500  
 PO BOX 159 CABOOLTURE QLD 4510  
 Telephone: (07) 3480 6666  
 Fax: (07) 3480 6710

**ROADS AND DRAINAGE**  
**AS CONSTRUCTED**  
**RIDGEVIEW - STAGE 10**  
**RAYNBIRD ROAD, NARANGBA**

MBRC SUBDIVISION REFERENCE	
DA/2022/5067	
No. 1 OF 3 PLANS	
ASCON GRID NUMBER	REV.
	0

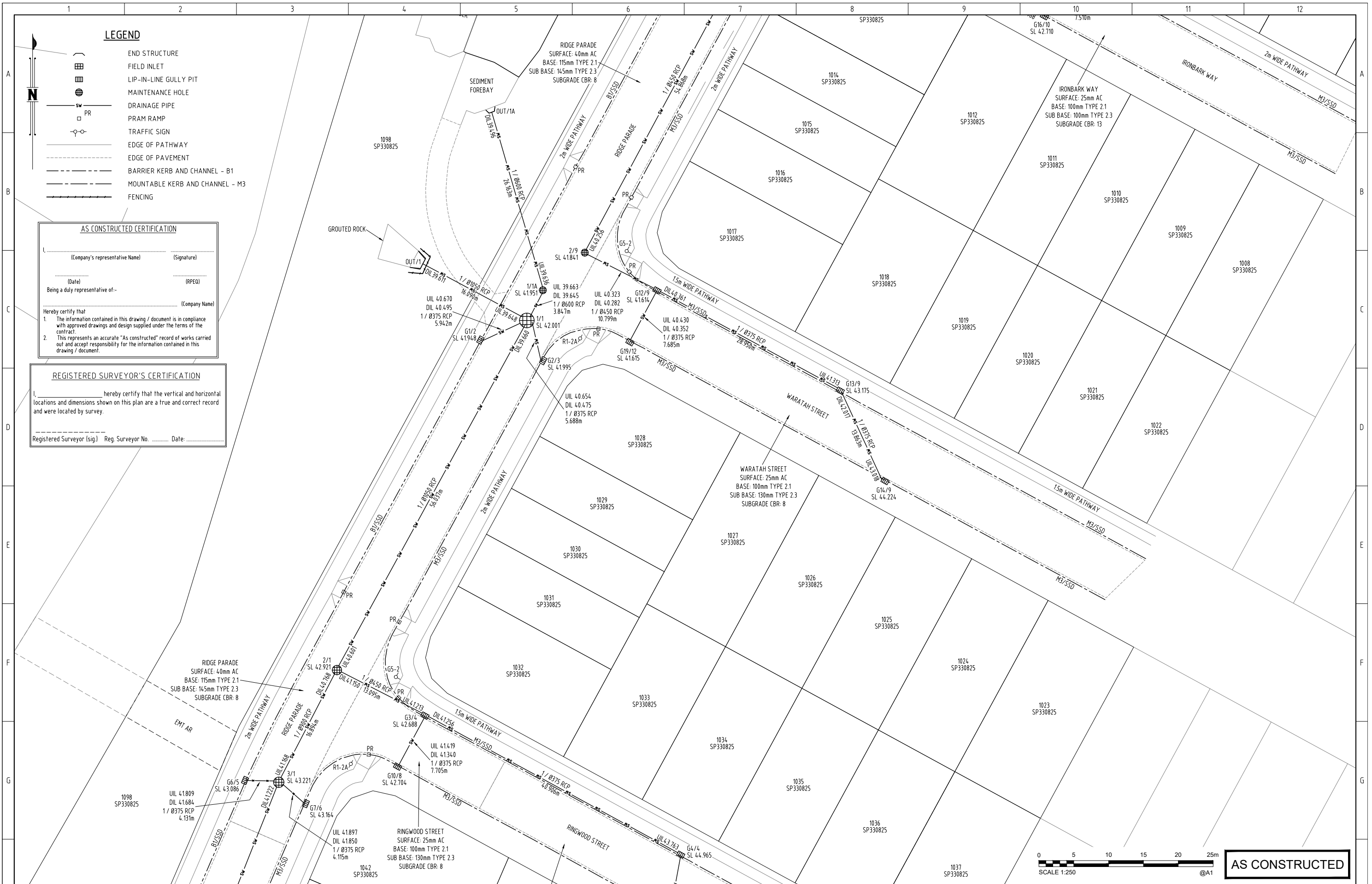

**AS CONSTRUCTED CERTIFICATION**

I, \_\_\_\_\_ (Company's representative Name) \_\_\_\_\_ (Signature)  
 \_\_\_\_\_ (Date) \_\_\_\_\_ (RPEQ)  
 Being a duly representative of- \_\_\_\_\_ (Company Name)

Hereby certify that

- The information contained in this drawing / document is in compliance with approved drawings and design supplied under the terms of the contract.
- This represents an accurate "As constructed" record of works carried out and accept responsibility for the information contained in this drawing / document.

**REGISTERED SURVEYOR'S CERTIFICATION**

I, \_\_\_\_\_ hereby certify that the vertical and horizontal locations and dimensions shown on this plan are a true and correct record and were located by survey.

Registered Surveyor (sig.) Reg. Surveyor No. \_\_\_\_\_ Date: \_\_\_\_\_

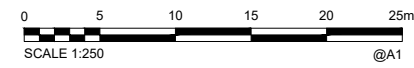

**AS CONSTRUCTED**

DRAWING REVISIONS		REFERENCE DRAWINGS		DESIGN FILE No.	DESIGNED
REV.	REVISION DESCRIPTION	DRG. No.	DESCRIPTION	CONSTRUCT. No.	DATE
0	AS-CONSTRUCTED DRAWINGS				
				SURVEY FILE No.	DRAWN BAS
				FIELD BOOK	DATE 17/01/2024
				LOG BOOK	CHECKED DL
				LEVEL DATUM	DATE 17/01/2024
				DATUM	

**THIS WORK WAS PREPARED BY:**

Lion Systems on behalf of SHADFORTH

SCALE 1:250 ORIGINAL SIZE A1

**MORETON BAY REGIONAL COUNCIL**  
 PINE DISTRICT OFFICE  
 220 GYMPIE ROAD STRATHPINE QLD 4500  
 PO BOX 159 CABOOLTURE QLD 4510  
 Telephone: (07) 3480 8686  
 Fax: (07) 3480 6710

**ROADS AND DRAINAGE**  
**AS CONSTRUCTED**  
**RIDGEVIEW - STAGE 10**  
**RAYNBIRD ROAD, NARANGBA**

MBRC SUBDIVISION REFERENCE	
DA/2022/5067	
No. 2 OF 3 PLANS	
ASCON GRID NUMBER	REV.
	0

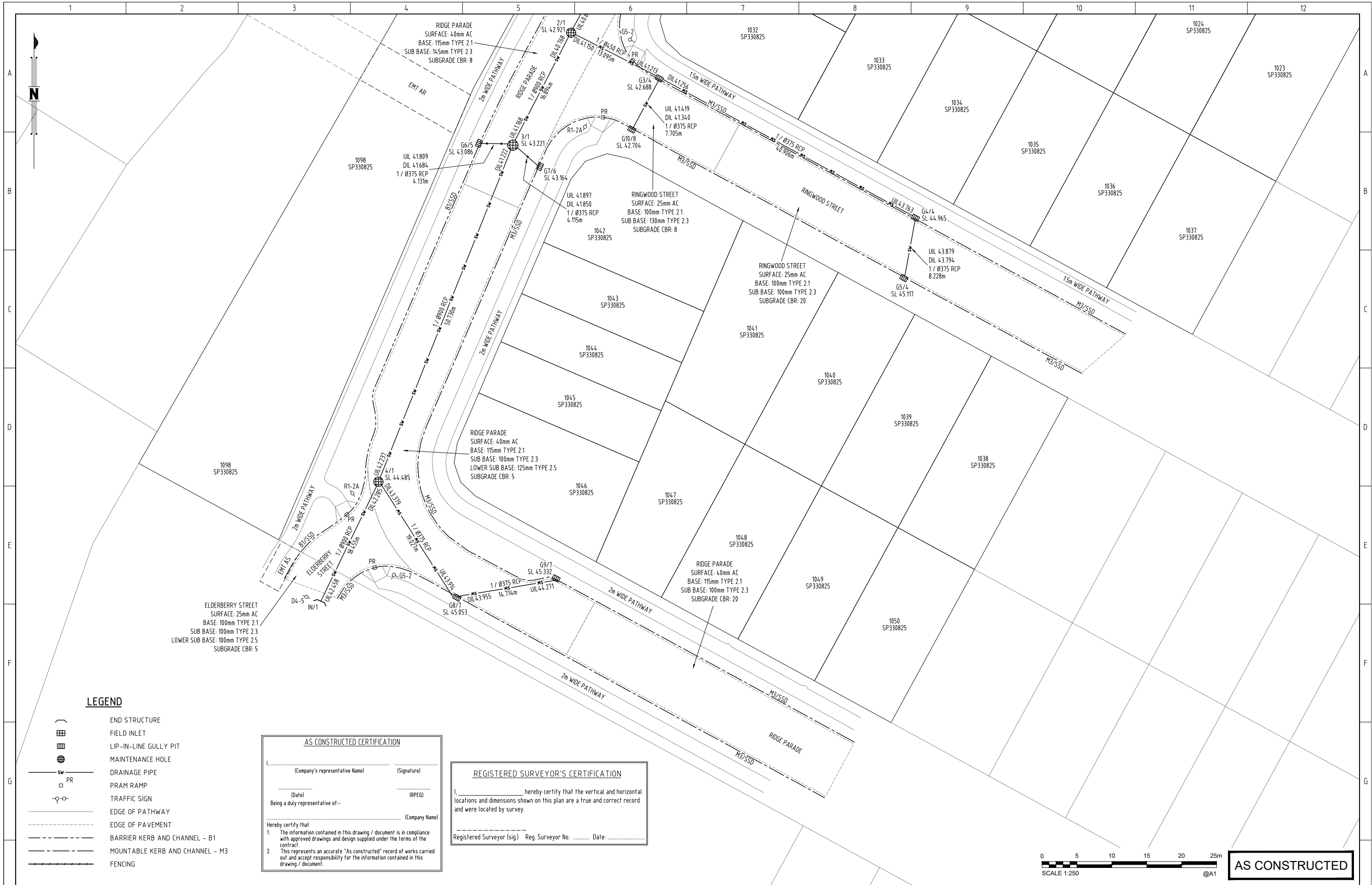

**LEGEND**

- ( ) END STRUCTURE
- ▣ FIELD INLET
- ▣ LIP-IN-LINE GULLY PIT
- ⊕ MAINTENANCE HOLE
- SW — DRAINAGE PIPE
- PR PRAM RAMP
- ⊕ TRAFFIC SIGN
- EDGE OF PATHWAY
- EDGE OF PAVEMENT
- BARRIER KERB AND CHANNEL - B1
- MOUNTABLE KERB AND CHANNEL - M3
- FENCING

**AS CONSTRUCTED CERTIFICATION**

I, \_\_\_\_\_ (Company's representative Name) \_\_\_\_\_ (Signature)  
 \_\_\_\_\_ (Date) \_\_\_\_\_ (RPEQ)  
 Being a duly representative of - \_\_\_\_\_ (Company Name)

Hereby certify that  
 1. The information contained in this drawing / document is in compliance with approved drawings and design supplied under the terms of the contract.  
 2. This represents an accurate "As constructed" record of works carried out and accept responsibility for the information contained in this drawing / document.

**REGISTERED SURVEYOR'S CERTIFICATION**

I, \_\_\_\_\_ hereby certify that the vertical and horizontal locations and dimensions shown on this plan are a true and correct record and were located by survey.

Registered Surveyor (sig.) Reg. Surveyor No. \_\_\_\_\_ Date: \_\_\_\_\_

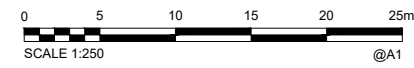

**AS CONSTRUCTED**

DRAWING REVISIONS		REFERENCE DRAWINGS		DESIGN FILE No.	DESIGNED
REV.	REVISION DESCRIPTION	DRG. No.	DESCRIPTION	CONSTRUCT. No.	DATE
0	AS-CONSTRUCTED DRAWINGS			SURVEY FILE No.	DRAWN BAS
				FIELD BOOK	DATE 17/01/2024
				LOG BOOK	CHECKED DL
				LEVEL DATUM	DATE 17/01/2024
				DATUM	

**THIS WORK WAS PREPARED BY:**

Lion Systems on behalf of SHADFORTH

SCALE 1:250 ORIGINAL SIZE A1



**MORETON BAY REGIONAL COUNCIL**  
 PINE DISTRICT OFFICE  
 220 GYMPIE ROAD STRATHPINE QLD 4500  
 PO BOX 159 CABOOLTURE QLD 4510  
 Telephone: (07) 3480 8686  
 Fax: (07) 3480 6710

**ROADS AND DRAINAGE  
 AS CONSTRUCTED  
 RIDGEVIEW - STAGE 10  
 RAYNBIRD ROAD, NARANGBA**

MBRC SUBDIVISION REFERENCE	
DA/2022/5067	
No. 3 OF 3 PLANS	
ASCAN GRID NUMBER	REV.
	0