

LOCATION DIAGRAM

SCALE 1:4000

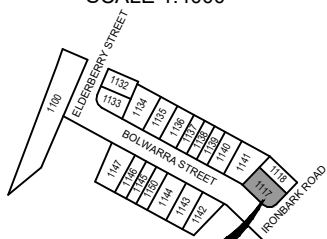

LOT 1117

RETAINING WALL	
Min. Height	1.15m
Max. Height	1.15m
Av. Height	1.15m

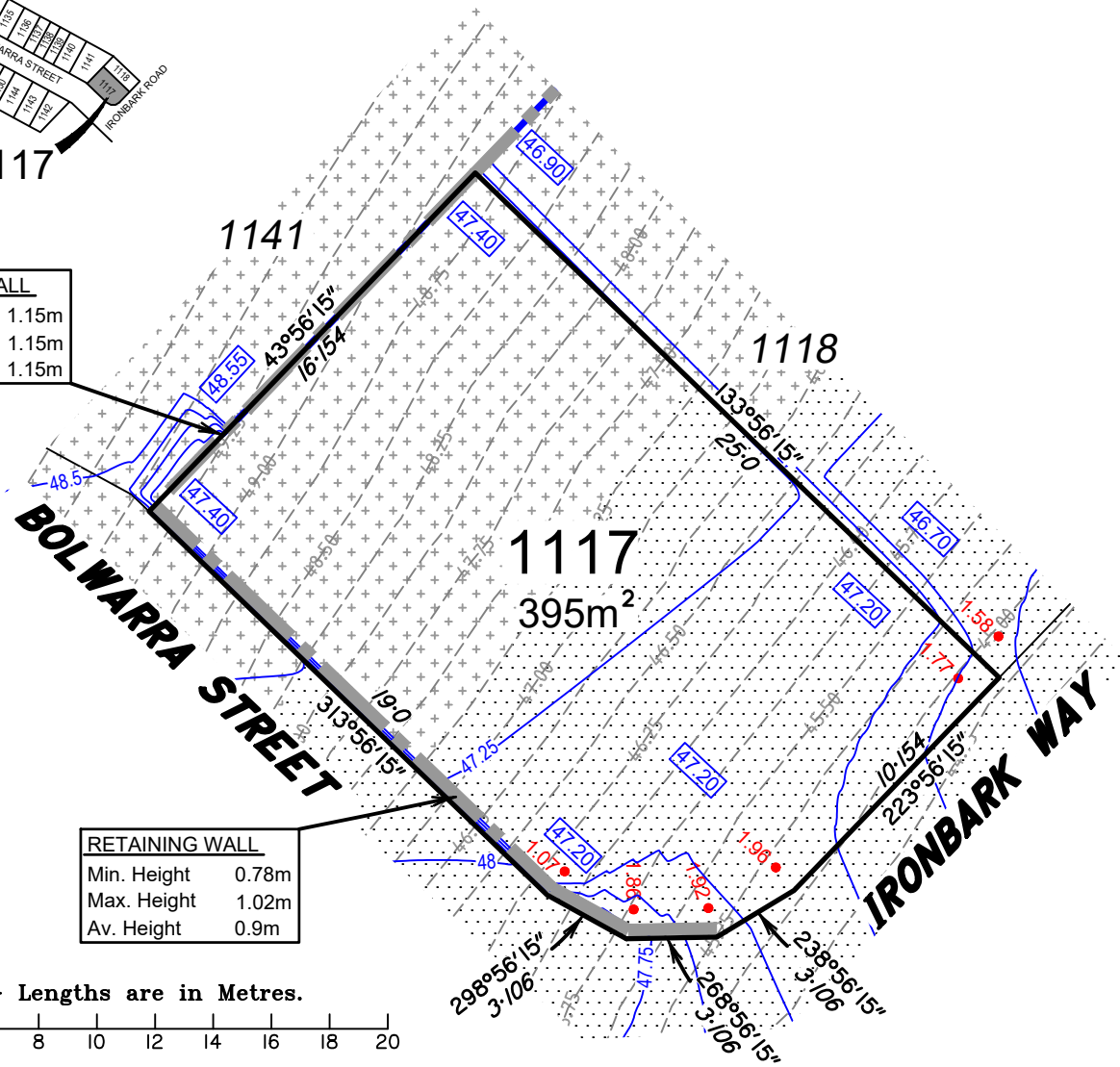

RETAINING WALL	
Min. Height	0.78m
Max. Height	1.02m
Av. Height	0.9m

Scale 1:250 - Lengths are in Metres.

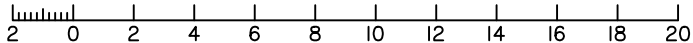

Important notes

- (1) This plan was produced for the exclusive use of SATTERLEY NARANGBA PTY LTD. It is to be used only for the purpose of Disclosure under the Land Sales Act (QLD).
- (2) This plan shows details of Proposed Allotment 1117 as described as part of Lot 3012 on SP330809 situated in the Locality of Narangba, Moreton Bay Regional.
- (3) All dimensions and areas are subject to final registration of the survey plan.
- (4) Levels shown are referenced to Australian Height Datum
- (5) Purchasers should contact the local authority to verify levels and the location of services before submitting building plans for approval.
- (6) The subject site may be affected by building envelope requirements. Purchasers should refer to the Reconfiguration of a Lot and/or Material Change of Use approvals if applicable.
- (7) Engineering design received from COLLIERS ENGINEERING & DESIGN on the 20 November 2023.
- (8) Proposed Lot Layout taken from ROL plan 18-0084-PS22 Rev J. Pending Approval by Moreton Bay Regional Council.
- (9) These notes form an integral part of this plan. If others use this information, they should be advised of its purpose and limitations.
- (10) This plan was prepared to satisfy Section 11 of the Land Sales Act QLD 1984.
- (11) Builders shall not build from the design levels shown. A site survey is required.
- (12) All fill to be compacted in accordance with A.S.3798-2007. Please refer to A.S.3798 for testing requirements.
- (13) This plan may not be reproduced unless these notes are included.



BRISBANE
Level 3, 120 Edward Street
Brisbane QLD 4000
GPO Box 1272
Brisbane QLD 4001

T 61 7 3837 9000
www.fyfe.com.au

Fyfe Pty Ltd (ACN 008 116 130) hereby certify that the corporation, by John David MORROW, Cadastral Surveyor for whose work the corporation accepts responsibility, has prepared this plan.

LEGEND:

- 13.0 — Design contours
— Contour Interval 0.5m (AHD)
- 13.75 — Natural Surface Contours prior to earthworks
— Contour Interval 0.25m (AHD)
- Retaining Wall (Design location)
Indicative heights shown to wall.
Heights subject to final design.
- 2.25 Depth of fill in metres shown thus
- 61.30 Design Earthworks Pad Levels
- + + + AREAS TO BE FILLED
- + + + AREAS TO BE CUT



DISCLOSURE PLAN
FOR PROPOSED LOT 1117
Currently described as:
Part of Lot 3012 on SP330809
Locality: NARANGBA
LGA: Moreton Bay Regional

DATE: 24/11/2023
SCALE: 1:250 @ A4

DRAWING NUMBER
49003-31_DP1117
Rev: A

LOCATION DIAGRAM

SCALE 1:5000

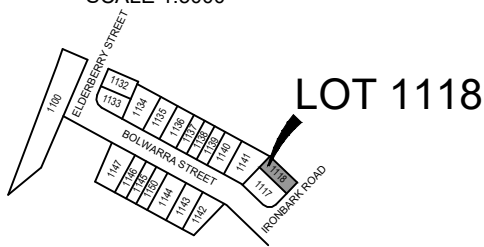

RETAINING WALL	
Min. Height	1.15m
Max. Height	1.15m
Av. Height	1.15m

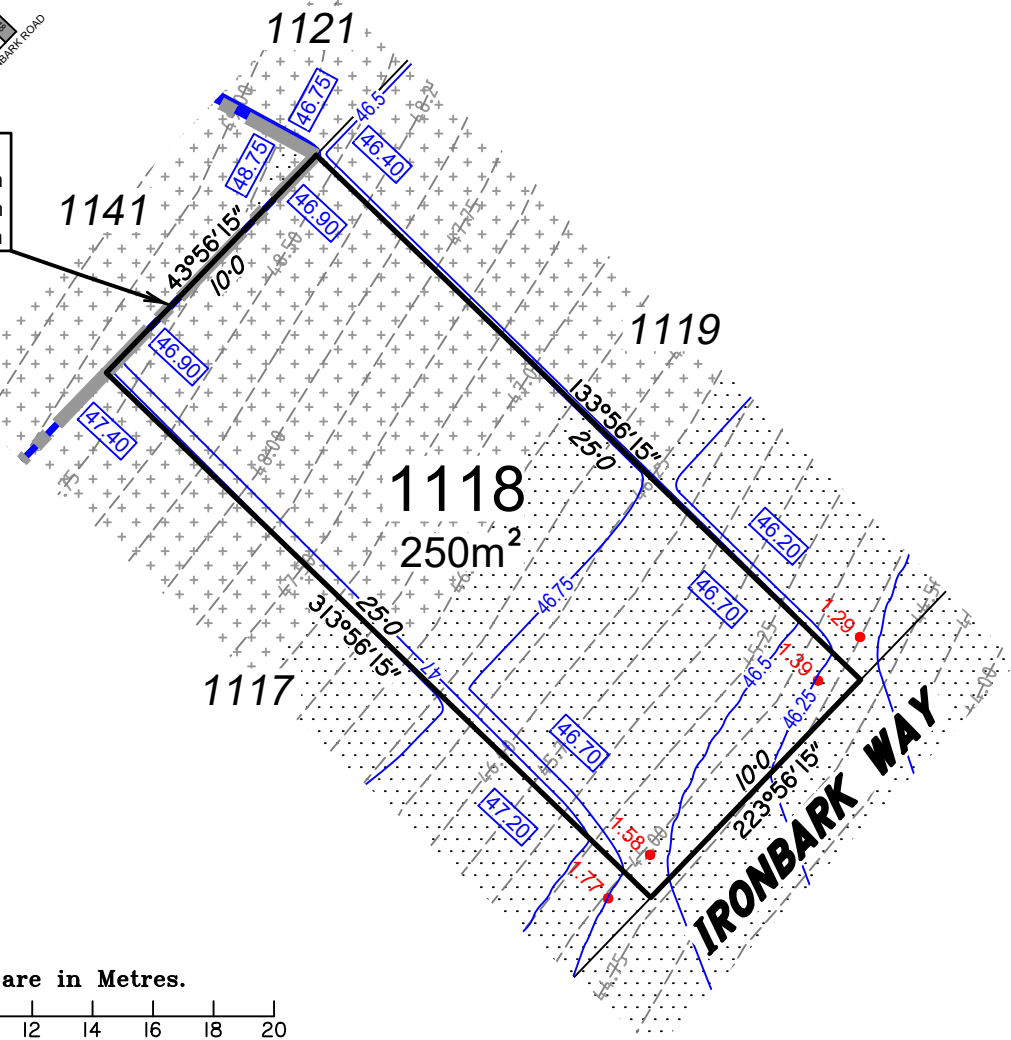

Important notes

- (1) This plan was produced for the exclusive use of SATTERLEY NARANGBA PTY LTD. It is to be used only for the purpose of Disclosure under the Land Sales Act (QLD).
- (2) This plan shows details of Proposed Allotment 1118 as described as part of Lot 3012 on SP330809 situated in the Locality of Narangba, Moreton Bay Regional.
- (3) All dimensions and areas are subject to final registration of the survey plan.
- (4) Levels shown are referenced to Australian Height Datum
- (5) Purchasers should contact the local authority to verify levels and the location of services before submitting building plans for approval.
- (6) The subject site may be affected by building envelope requirements. Purchasers should refer to the Reconfiguration of a Lot and/or Material Change of Use approvals if applicable.
- (7) Engineering design received from COLLIERS ENGINEERING & DESIGN on the 20 November 2023.
- (8) Proposed Lot Layout taken from ROL plan 18-0084-PS22 Rev J. Pending Approval by Moreton Bay Regional Council.
- (9) These notes form an integral part of this plan. If others use this information, they should be advised of its purpose and limitations.
- (10) This plan was prepared to satisfy Section 11 of the Land Sales Act QLD 1984.
- (11) Builders shall not build from the design levels shown. A site survey is required.
- (12) All fill to be compacted in accordance with A.S.3798-2007. Please refer to A.S.3798 for testing requirements.
- (13) This plan may not be reproduced unless these notes are included.

FYFE Fyfe Pty Ltd (ACN 008 116 130) hereby certify that the corporation, by John David MORROW, Cadastral Surveyor for whose work the corporation accepts responsibility, has prepared this plan.

BRISBANE
Level 3, 120 Edward Street
Brisbane QLD 4000
GPO Box 1272
Brisbane QLD 4001

T 61 7 3837 9000
www.fyfe.com.au

LEGEND:

- 13.0 Design contours
- Contour Interval 0.5m (AHD)
- 13.75 Natural Surface Contours prior to earthworks
- Contour Interval 0.25m (AHD)
- Retaining Wall (Design location)
Indicative heights shown to wall.
Heights subject to final design.
- 2.25 Depth of fill in metres shown thus
- 61.30 Design Earthworks Pad Levels
- AREAS TO BE FILLED
- AREAS TO BE CUT

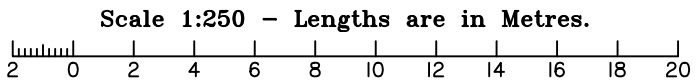

DISCLOSURE PLAN
FOR PROPOSED LOT 1118
Currently described as:
Part of Lot 3012 on SP330809
Locality: NARANGBA
LGA: Moreton Bay Regional

DATE: 24/11/2023
SCALE: 1:250 @ A4

DRAWING NUMBER
49003-31_DP1118
Rev: A

LOCATION DIAGRAM

SCALE 1:5000

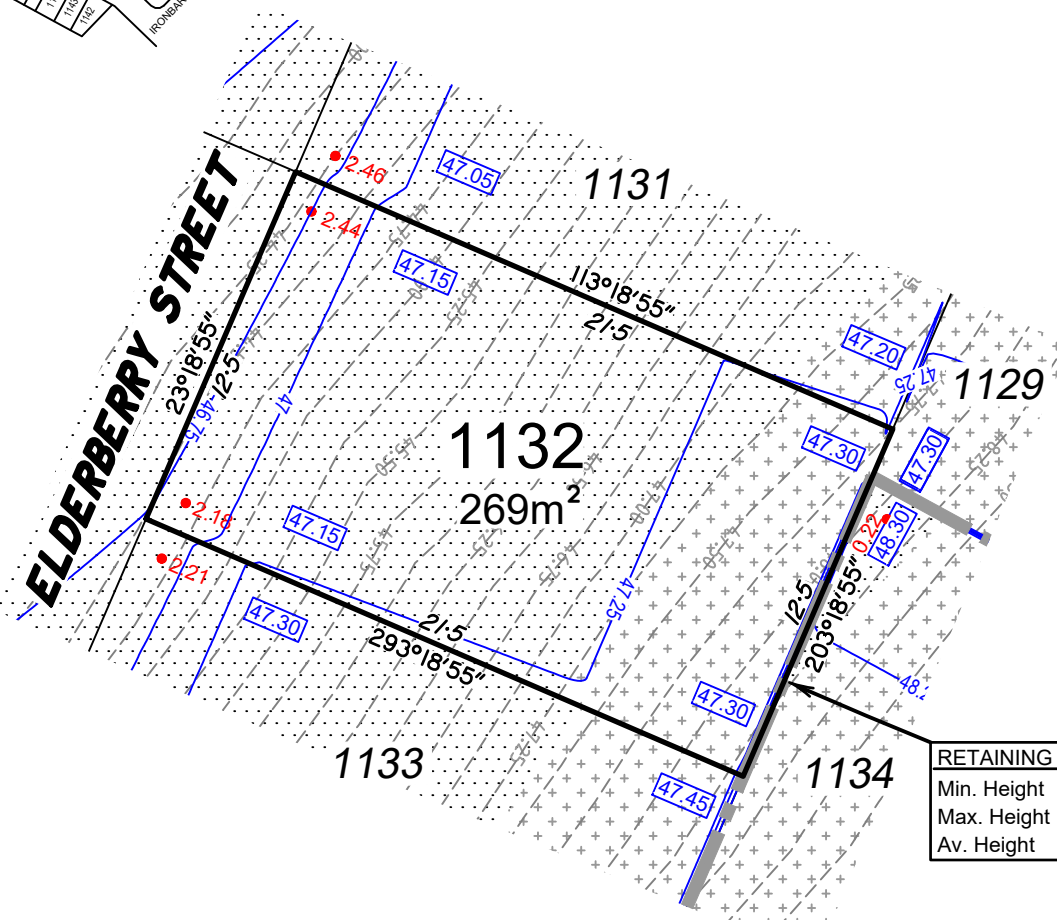
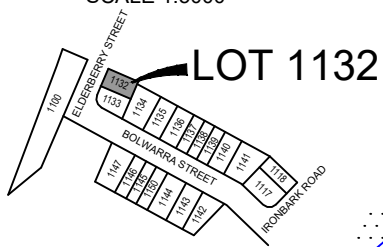

RETAINING WALL	
Min. Height	1.0m
Max. Height	1.0m
Average Height	1.0m

Important notes

- (1) This plan was produced for the exclusive use of SATTERLEY NARANGBA PTY LTD. It is to be used only for the purpose of Disclosure under the Land Sales Act (QLD).
- (2) This plan shows details of Proposed Allotment 1132 as described as part of Lot 3012 on SP330809 situated in the Locality of Narangba, Moreton Bay Regional.
- (3) All dimensions and areas are subject to final registration of the survey plan.
- (4) Levels shown are referenced to Australian Height Datum
- (5) Purchasers should contact the local authority to verify levels and the location of services before submitting building plans for approval.
- (6) The subject site may be affected by building envelope requirements. Purchasers should refer to the Reconfiguration of a Lot and/or Material Change of Use approvals if applicable.
- (7) Engineering design received from COLLIERS ENGINEERING & DESIGN on the 20 November 2023.
- (8) Proposed Lot Layout taken from ROL plan 18-0084-PS22 Rev J. Pending Approval by Moreton Bay Regional Council.
- (9) These notes form an integral part of this plan. If others use this information, they should be advised of its purpose and limitations.
- (10) This plan was prepared to satisfy Section 11 of the Land Sales Act QLD 1984.
- (11) Builders shall not build from the design levels shown. A site survey is required.
- (12) All fill to be compacted in accordance with A.S.3798-2007. Please refer to A.S.3798 for testing requirements.
- (13) This plan may not be reproduced unless these notes are included.

FYFE Fyfe Pty Ltd (ACN 008 116 130) hereby certify that the corporation, by John David MORROW, Cadastral Surveyor for whose work the corporation accepts responsibility, has prepared this plan.

BRISBANE
Level 3, 120 Edward Street
Brisbane QLD 4000
GPO Box 1272
Brisbane QLD 4001

T 61 7 3837 9000
www.fyfe.com.au

LEGEND:

- 13.0 — Design contours
— Contour Interval 0.5m (AHD)
- 13.75 — Natural Surface Contours prior to earthworks
— Contour Interval 0.25m (AHD)
- ▬▬▬ Retaining Wall (Design location)
Indicative heights shown to wall.
Heights subject to final design.
- 2.25 Depth of fill in metres shown thus
- 61.30 Design Earthworks Pad Levels
- AREAS TO BE FILLED
- + AREAS TO BE CUT

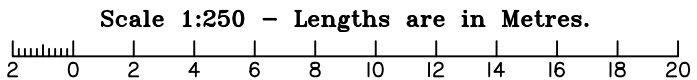

DISCLOSURE PLAN
FOR PROPOSED LOT 1132
Currently described as:
Part of Lot 3012 on SP330809
Locality: NARANGBA
LGA: Moreton Bay Regional

DATE: 24/11/2023
SCALE: 1:250 @ A4

DRAWING NUMBER
49003-31_DP1132
Rev: A

LOCATION DIAGRAM

SCALE 1:5000

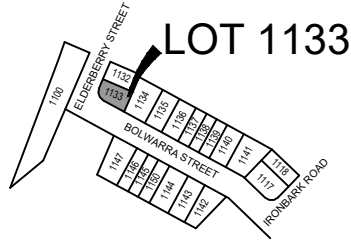

LOT 1133

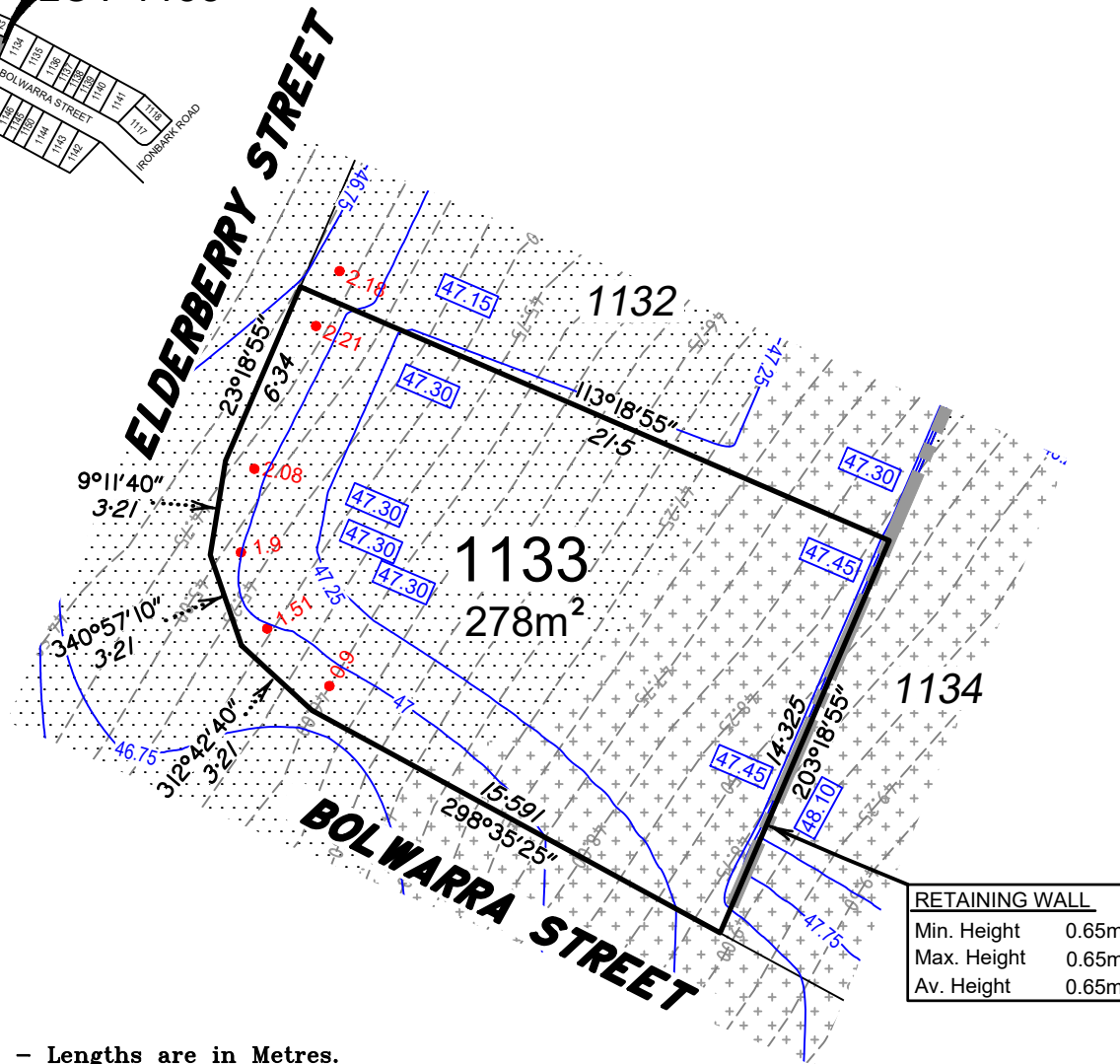

RETAINING WALL	
Min. Height	0.65m
Max. Height	0.65m
Av. Height	0.65m

Scale 1:250 - Lengths are in Metres.

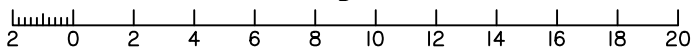

Important notes

- (1) This plan was produced for the exclusive use of SATTERLEY NARANGBA PTY LTD. It is to be used only for the purpose of Disclosure under the Land Sales Act (QLD).
- (2) This plan shows details of Proposed Allotment 1133 as described as part of Lot 3012 on SP330809 situated in the Locality of Narangba, Moreton Bay Regional.
- (3) All dimensions and areas are subject to final registration of the survey plan.
- (4) Levels shown are referenced to Australian Height Datum
- (5) Purchasers should contact the local authority to verify levels and the location of services before submitting building plans for approval.
- (6) The subject site may be affected by building envelope requirements. Purchasers should refer to the Reconfiguration of a Lot and/or Material Change of Use approvals if applicable.
- (7) Engineering design received from COLLIERS ENGINEERING & DESIGN on the 20 November 2023.
- (8) Proposed Lot Layout taken from ROL plan 18-0084-PS22 Rev J. Pending Approval by Moreton Bay Regional Council.
- (9) These notes form an integral part of this plan. If others use this information, they should be advised of its purpose and limitations.
- (10) This plan was prepared to satisfy Section 11 of the Land Sales Act QLD 1984.
- (11) Builders shall not build from the design levels shown. A site survey is required.
- (12) All fill to be compacted in accordance with A.S.3798-2007. Please refer to A.S.3798 for testing requirements.
- (13) This plan may not be reproduced unless these notes are included.

FYFE Fyfe Pty Ltd (ACN 008 116 130) hereby certify that the corporation, by John David MORROW, Cadastral Surveyor for whose work the corporation accepts responsibility, has prepared this plan.

BRISBANE
Level 3, 120 Edward Street
Brisbane QLD 4000
GPO Box 1272
Brisbane QLD 4001

T 61 7 3837 9000
www.fyfe.com.au

LEGEND:

- 13.0 Design contours - Contour Interval 0.5m (AHD)
- 13.75 Natural Surface Contours prior to earthworks - Contour Interval 0.25m (AHD)
- Retaining Wall (Design location) Indicative heights shown to wall. Heights subject to final design.
- 2.25 Depth of fill in metres shown thus
- 61.30 Design Earthworks Pad Levels
- AREAS TO BE FILLED
- AREAS TO BE CUT



DISCLOSURE PLAN
FOR PROPOSED LOT 1133
Currently described as:
Part of Lot 3012 on SP330809
Locality: NARANGBA
LGA: Moreton Bay Regional

DATE: 24/11/2023
SCALE: 1:250 @ A4

DRAWING NUMBER
49003-31_DP1133
Rev: A

LOCATION DIAGRAM

SCALE 1:5000

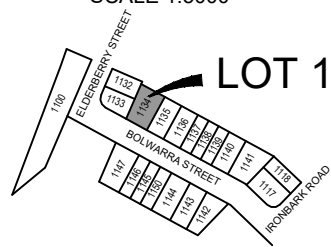

LOT 1134

RETAINING WALL	
Min. Height	1.0m
Max. Height	1.0m
Av. Height	1.0m

RETAINING WALL	
Min. Height	0.65m
Max. Height	0.65m
Av. Height	0.65m

RETAINING WALL	
Min. Height	1.0m
Max. Height	1.0m
Av. Height	1.0m

RETAINING WALL	
Min. Height	0.55m
Max. Height	0.55m
Av. Height	0.55m

RETAINING WALL	
Min. Height	0.75m
Max. Height	0.75m
Av. Height	0.75m

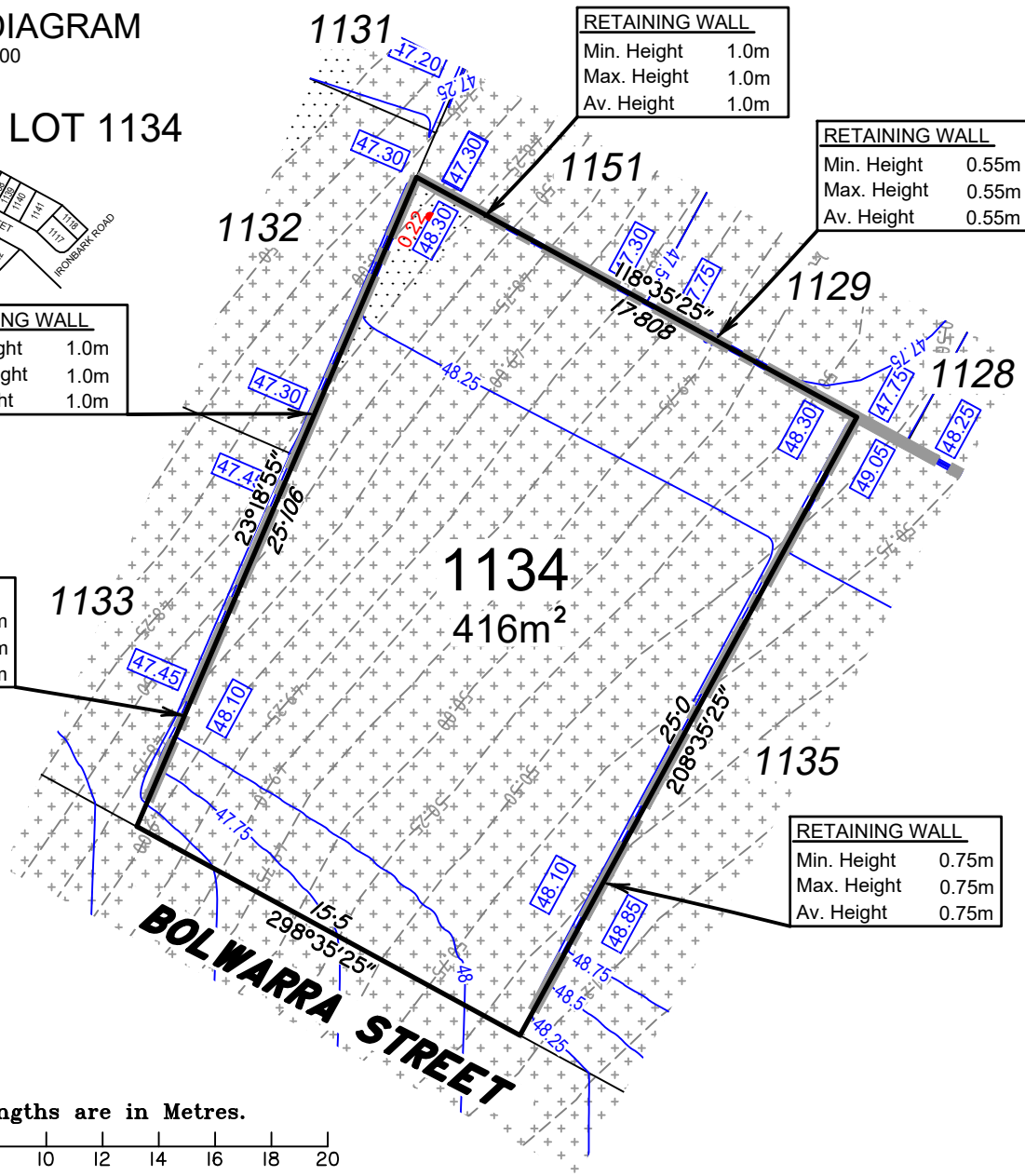

Scale 1:250 - Lengths are in Metres.

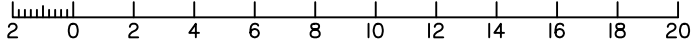

Important notes

- (1) This plan was produced for the exclusive use of SATTERLEY NARANGBA PTY LTD. It is to be used only for the purpose of Disclosure under the Land Sales Act (QLD).
- (2) This plan shows details of Proposed Allotment 1134 as described as part of Lot 3012 on SP330809 situated in the Locality of Narangba, Moreton Bay Regional.
- (3) All dimensions and areas are subject to final registration of the survey plan.
- (4) Levels shown are referenced to Australian Height Datum
- (5) Purchasers should contact the local authority to verify levels and the location of services before submitting building plans for approval.
- (6) The subject site may be affected by building envelope requirements. Purchasers should refer to the Reconfiguration of a Lot and/or Material Change of Use approvals if applicable.
- (7) Engineering design received from COLLIERS ENGINEERING & DESIGN on the 20 November 2023.
- (8) Proposed Lot Layout taken from ROL plan 18-0084-PS22 Rev J. Pending Approval by Moreton Bay Regional Council.
- (9) These notes form an integral part of this plan. If others use this information, they should be advised of its purpose and limitations.
- (10) This plan was prepared to satisfy Section 11 of the Land Sales Act QLD 1984.
- (11) Builders shall not build from the design levels shown. A site survey is required.
- (12) All fill to be compacted in accordance with A.S.3798-2007. Please refer to A.S.3798 for testing requirements.
- (13) This plan may not be reproduced unless these notes are included.

FYFE Fyfe Pty Ltd (ACN 008 116 130) hereby certify that the corporation, by John David MORROW, Cadastral Surveyor for whose work the corporation accepts responsibility, has prepared this plan.

BRISBANE
Level 3, 120 Edward Street
Brisbane QLD 4000
GPO Box 1272
Brisbane QLD 4001

T 61 7 3837 9000
www.fyfe.com.au

LEGEND:

- 13.0 Design contours - Contour Interval 0.5m (AHD)
- 13.75 Natural Surface Contours prior to earthworks - Contour Interval 0.25m (AHD)
- Retaining Wall (Design location) Indicative heights shown to wall. Heights subject to final design.
- 2.25 Depth of fill in metres shown thus
- 61.30 Design Earthworks Pad Levels
- AREAS TO BE FILLED
- AREAS TO BE CUT



DISCLOSURE PLAN
FOR PROPOSED LOT 1134
Currently described as:
Part of Lot 3012 on SP330809
Locality: NARANGBA
LGA: Moreton Bay Regional

DATE: 24/11/2023
SCALE: 1:250 @ A4

DRAWING NUMBER
49003-31_DP1134
Rev: A

LOCATION DIAGRAM

SCALE 1:5000

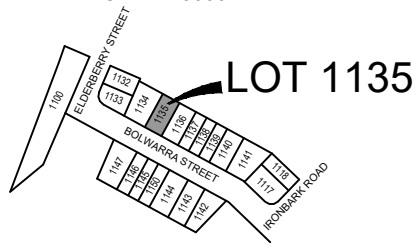

RETAINING WALL	
Min. Height	0.75m
Max. Height	0.75m
Av. Height	0.75m

RETAINING WALL	
Min. Height	0.8m
Max. Height	0.8m
Av. Height	0.8m

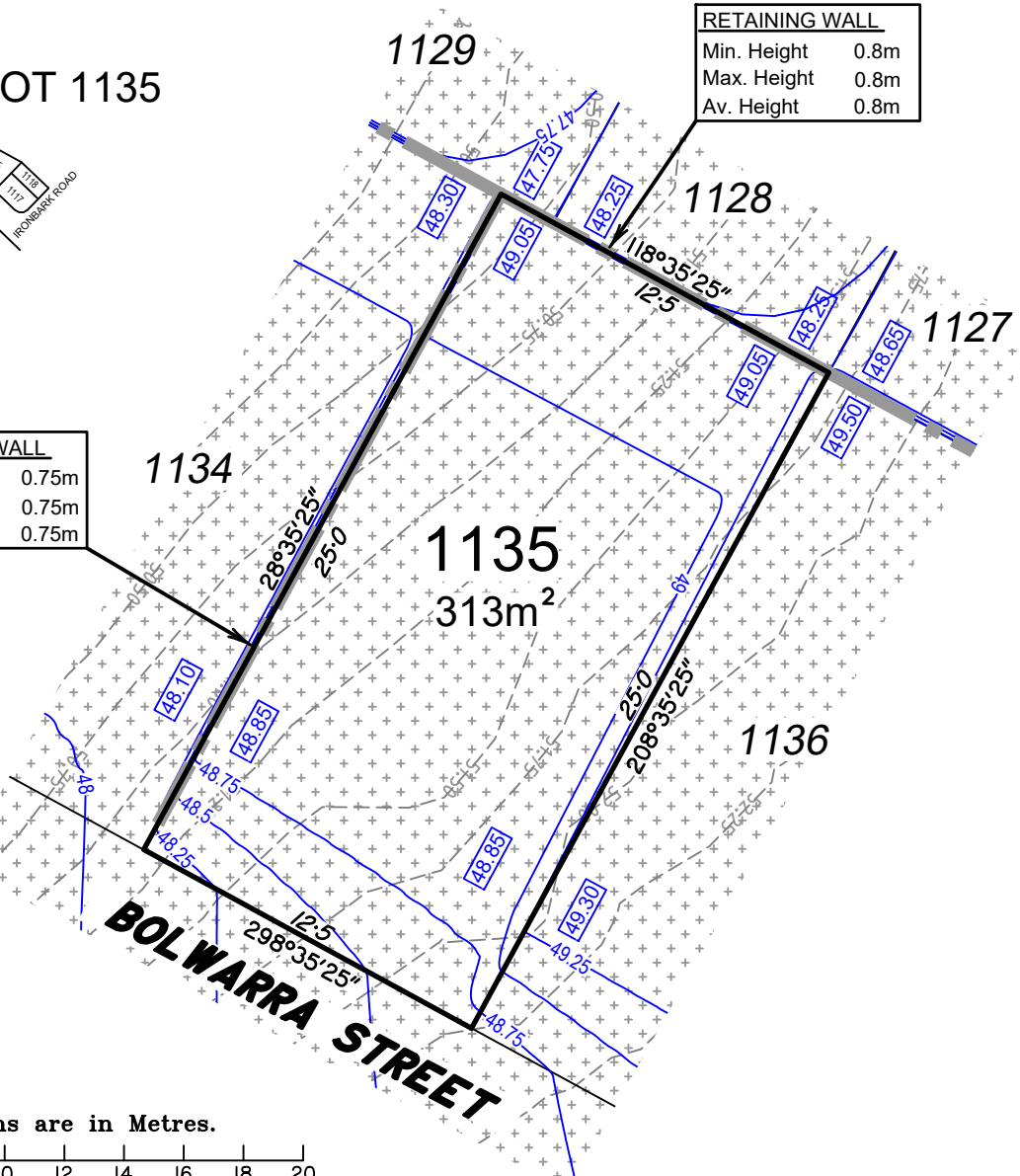

Scale 1:250 - Lengths are in Metres.

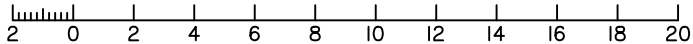

- ### Important notes
- (1) This plan was produced for the exclusive use of SATTERLEY NARANGBA PTY LTD. It is to be used only for the purpose of Disclosure under the Land Sales Act (QLD).
 - (2) This plan shows details of Proposed Allotment 1135 as described as part of Lot 3012 on SP330809 situated in the Locality of Narangba, Moreton Bay Regional.
 - (3) All dimensions and areas are subject to final registration of the survey plan.
 - (4) Levels shown are referenced to Australian Height Datum
 - (5) Purchasers should contact the local authority to verify levels and the location of services before submitting building plans for approval.
 - (6) The subject site may be affected by building envelope requirements. Purchasers should refer to the Reconfiguration of a Lot and/or Material Change of Use approvals if applicable.
 - (7) Engineering design received from COLLIERS ENGINEERING & DESIGN on the 20 November 2023.
 - (8) Proposed Lot Layout taken from ROL plan 18-0084-PS22 Rev J. Pending Approval by Moreton Bay Regional Council.
 - (9) These notes form an integral part of this plan. If others use this information, they should be advised of its purpose and limitations.
 - (10) This plan was prepared to satisfy Section 11 of the Land Sales Act QLD 1984.
 - (11) Builders shall not build from the design levels shown. A site survey is required.
 - (12) All fill to be compacted in accordance with A.S.3798-2007. Please refer to A.S.3798 for testing requirements.
 - (13) This plan may not be reproduced unless these notes are included.

FYFE Fyfe Pty Ltd (ACN 008 116 130) hereby certify that the corporation, by John David MORROW, Cadastral Surveyor for whose work the corporation accepts responsibility, has prepared this plan.

BRISBANE
Level 3, 120 Edward Street
Brisbane QLD 4000
GPO Box 1272
Brisbane QLD 4001

T 61 7 3837 9000
www.fyfe.com.au

LEGEND:

- 13.0 — Design contours
— Contour Interval 0.5m (AHD)
- 13.75 — Natural Surface Contours prior to earthworks
— Contour Interval 0.25m (AHD)
- ■ — Retaining Wall (Design location)
Indicative heights shown to wall.
Heights subject to final design.
- 2.25 Depth of fill in metres shown thus
- 61.30 Design Earthworks Pad Levels
- ▨ AREAS TO BE FILLED
- ⊕ AREAS TO BE CUT



DISCLOSURE PLAN
FOR PROPOSED LOT 1135
Currently described as:
Part of Lot 3012 on SP330809
Locality: NARANGBA
LGA: Moreton Bay Regional

DATE: 24/11/2023
SCALE: 1:250 @ A4

DRAWING NUMBER
49003-31_DP1135
Rev: A

LOCATION DIAGRAM

SCALE 1:5000

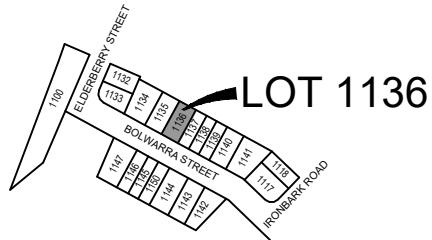

LOT 1136

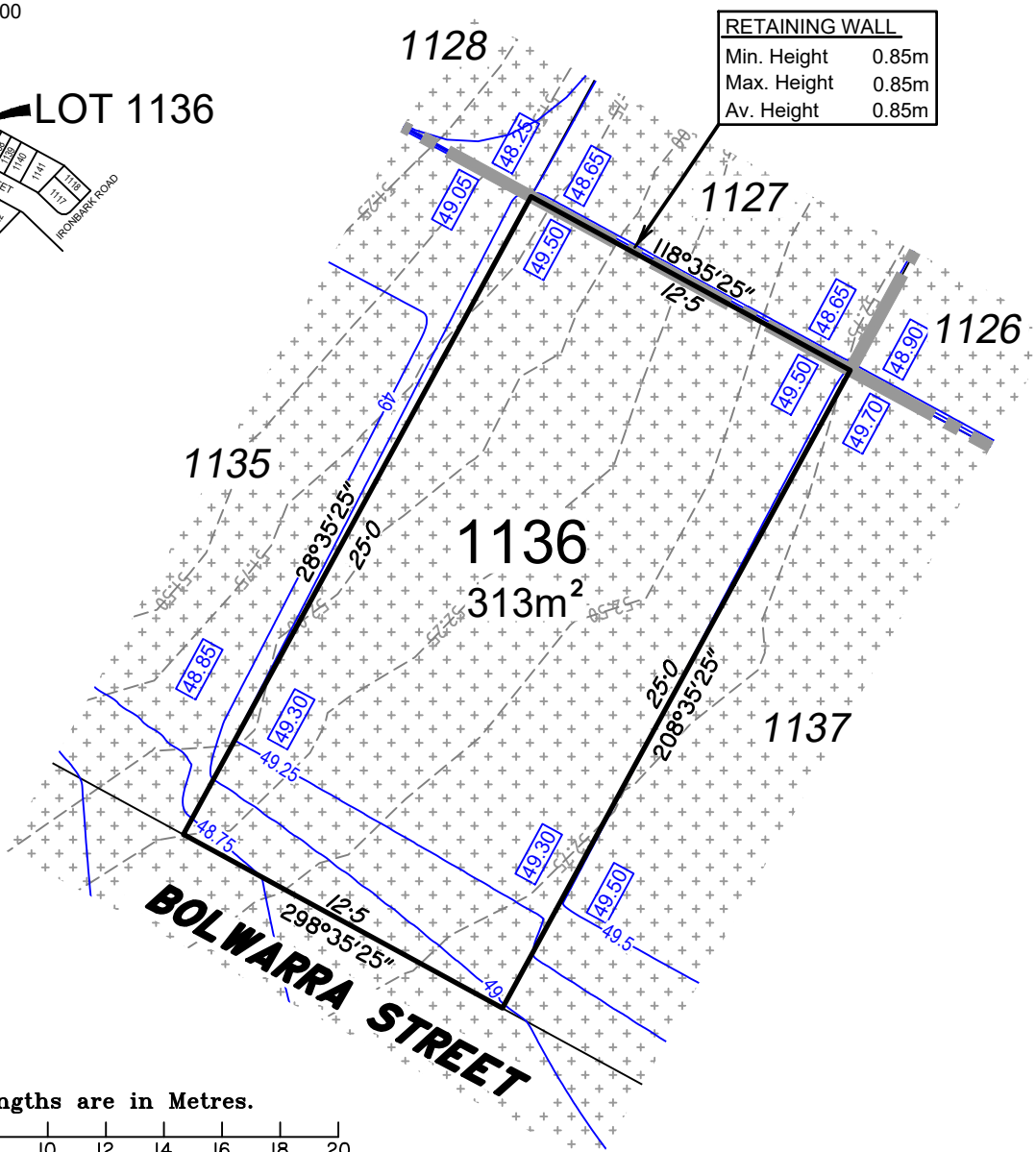

RETAINING WALL	
Min. Height	0.85m
Max. Height	0.85m
Av. Height	0.85m

Important notes

- (1) This plan was produced for the exclusive use of SATTERLEY NARANGBA PTY LTD. It is to be used only for the purpose of Disclosure under the Land Sales Act (QLD).
- (2) This plan shows details of Proposed Allotment 1136 as described as part of Lot 3012 on SP330809 situated in the Locality of Narangba, Moreton Bay Regional.
- (3) All dimensions and areas are subject to final registration of the survey plan.
- (4) Levels shown are referenced to Australian Height Datum
- (5) Purchasers should contact the local authority to verify levels and the location of services before submitting building plans for approval.
- (6) The subject site may be affected by building envelope requirements. Purchasers should refer to the Reconfiguration of a Lot and/or Material Change of Use approvals if applicable.
- (7) Engineering design received from COLLIERS ENGINEERING & DESIGN on the 20 November 2023.
- (8) Proposed Lot Layout taken from ROL plan 18-0084-PS22 Rev J. Pending Approval by Moreton Bay Regional Council.
- (9) These notes form an integral part of this plan. If others use this information, they should be advised of its purpose and limitations.
- (10) This plan was prepared to satisfy Section 11 of the Land Sales Act QLD 1984.
- (11) Builders shall not build from the design levels shown. A site survey is required.
- (12) All fill to be compacted in accordance with A.S.3798-2007. Please refer to A.S.3798 for testing requirements.
- (13) This plan may not be reproduced unless these notes are included.

FYFE Fyfe Pty Ltd (ACN 008 116 130) hereby certify that the corporation, by John David MORROW, Cadastral Surveyor for whose work the corporation accepts responsibility, has prepared this plan.

BRISBANE
Level 3, 120 Edward Street
Brisbane QLD 4000
GPO Box 1272
Brisbane QLD 4001

T 61 7 3837 9000
www.fyfe.com.au

LEGEND:

- 13.0 — Design contours
— Contour Interval 0.5m (AHD)
- 13.75 — Natural Surface Contours prior to earthworks
— Contour Interval 0.25m (AHD)
- Retaining Wall (Design location)
Indicative heights shown to wall.
Heights subject to final design.
- 2.25 Depth of fill in metres shown thus
- 61.30 Design Earthworks Pad Levels
- AREAS TO BE FILLED
- +
 AREAS TO BE CUT

Scale 1:250 - Lengths are in Metres.

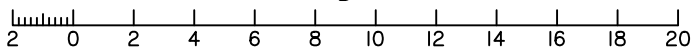

DISCLOSURE PLAN
FOR PROPOSED LOT 1136
Currently described as:
Part of Lot 3012 on SP330809
Locality: NARANGBA
LGA: Moreton Bay Regional

DATE: 24/11/2023
SCALE: 1:250 @ A4

DRAWING NUMBER
49003-31_DP1136
Rev: A

LOCATION DIAGRAM

SCALE 1:5000

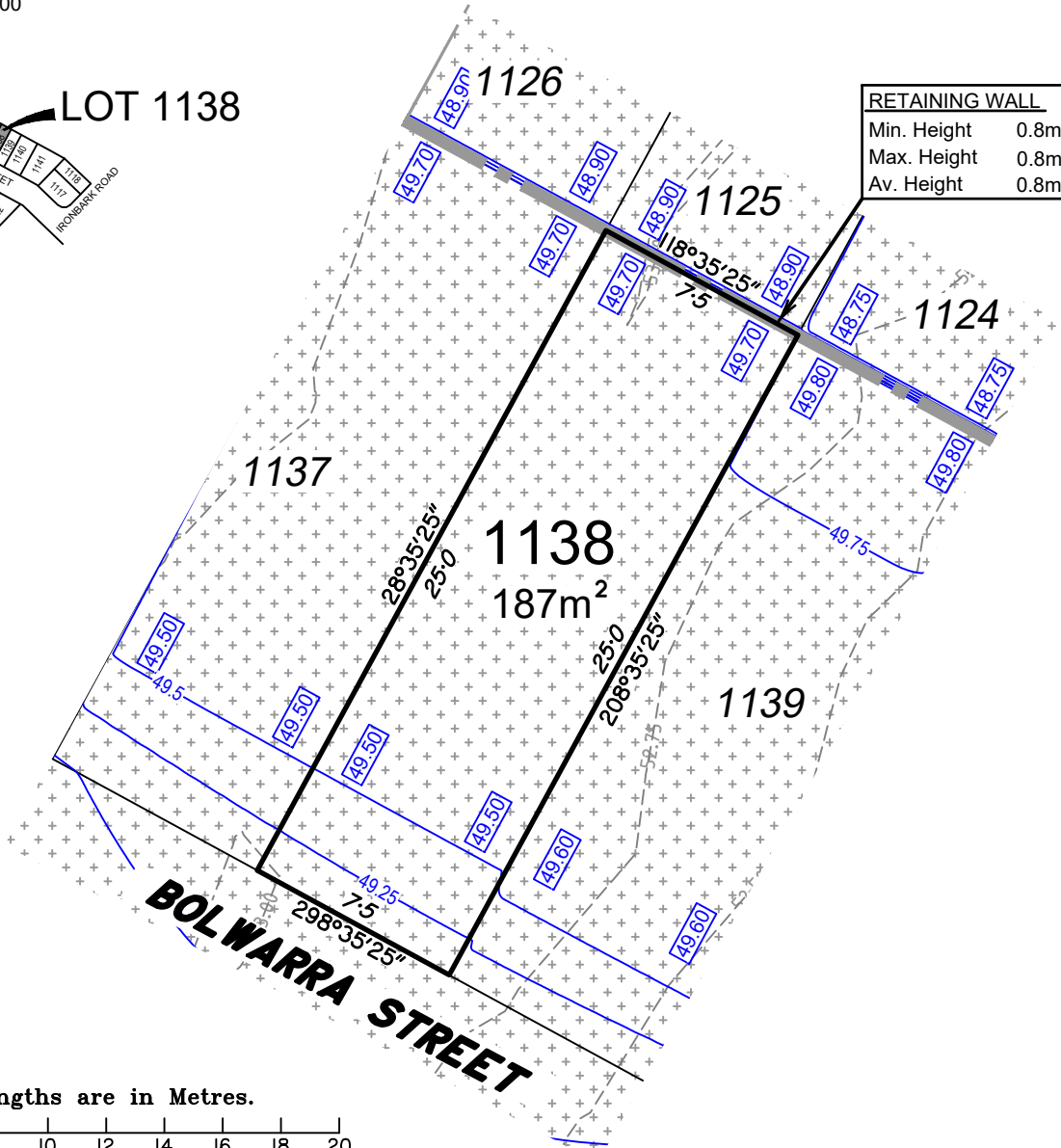
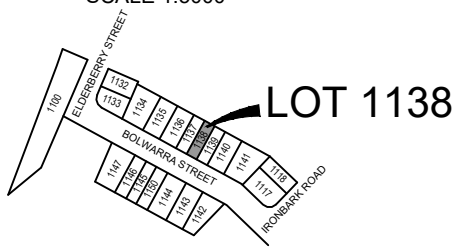

RETAINING WALL	
Min. Height	0.8m
Max. Height	0.8m
Av. Height	0.8m

Important notes

- (1) This plan was produced for the exclusive use of SATTERLEY NARANGBA PTY LTD. It is to be used only for the purpose of Disclosure under the Land Sales Act (QLD).
- (2) This plan shows details of Proposed Allotment 1138 as described as part of Lot 3012 on SP330809 situated in the Locality of Narangba, Moreton Bay Regional.
- (3) All dimensions and areas are subject to final registration of the survey plan.
- (4) Levels shown are referenced to Australian Height Datum
- (5) Purchasers should contact the local authority to verify levels and the location of services before submitting building plans for approval.
- (6) The subject site may be affected by building envelope requirements. Purchasers should refer to the Reconfiguration of a Lot and/or Material Change of Use approvals if applicable.
- (7) Engineering design received from COLLIERS ENGINEERING & DESIGN on the 20 November 2023.
- (8) Proposed Lot Layout taken from ROL plan 18-0084-PS22 Rev J. Pending Approval by Moreton Bay Regional Council.
- (9) These notes form an integral part of this plan. If others use this information, they should be advised of its purpose and limitations.
- (10) This plan was prepared to satisfy Section 11 of the Land Sales Act QLD 1984.
- (11) Builders shall not build from the design levels shown. A site survey is required.
- (12) All fill to be compacted in accordance with A.S.3798-2007. Please refer to A.S.3798 for testing requirements.
- (13) This plan may not be reproduced unless these notes are included.

FYFE Fyfe Pty Ltd (ACN 008 116 130) hereby certify that the corporation, by John David MORROW, Cadastral Surveyor for whose work the corporation accepts responsibility, has prepared this plan.

BRISBANE
Level 3, 120 Edward Street
Brisbane QLD 4000
GPO Box 1272
Brisbane QLD 4001

T 61 7 3837 9000
www.fyfe.com.au

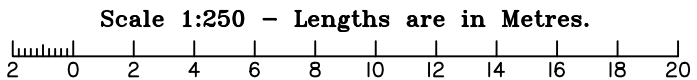

DISCLOSURE PLAN
FOR PROPOSED LOT 1138
Currently described as:
Part of Lot 3012 on SP330809
Locality: NARANGBA
LGA: Moreton Bay Regional

DATE: 24/11/2023
SCALE: 1:250 @ A4

DRAWING NUMBER
49003-31_DP1138
Rev: A

LEGEND:

- 13.0 — Design contours
— Contour Interval 0.5m (AHD)
- 13.75 — Natural Surface Contours prior to earthworks
— Contour Interval 0.25m (AHD)
- ▬▬▬ Retaining Wall (Design location)
Indicative heights shown to wall.
Heights subject to final design.
- 2.25 Depth of fill in metres shown thus
- 61.30 Design Earthworks Pad Levels
- ▨ AREAS TO BE FILLED
- ▩ AREAS TO BE CUT

LOCATION DIAGRAM

SCALE 1:5000

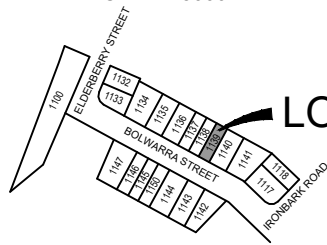

LOT 1139

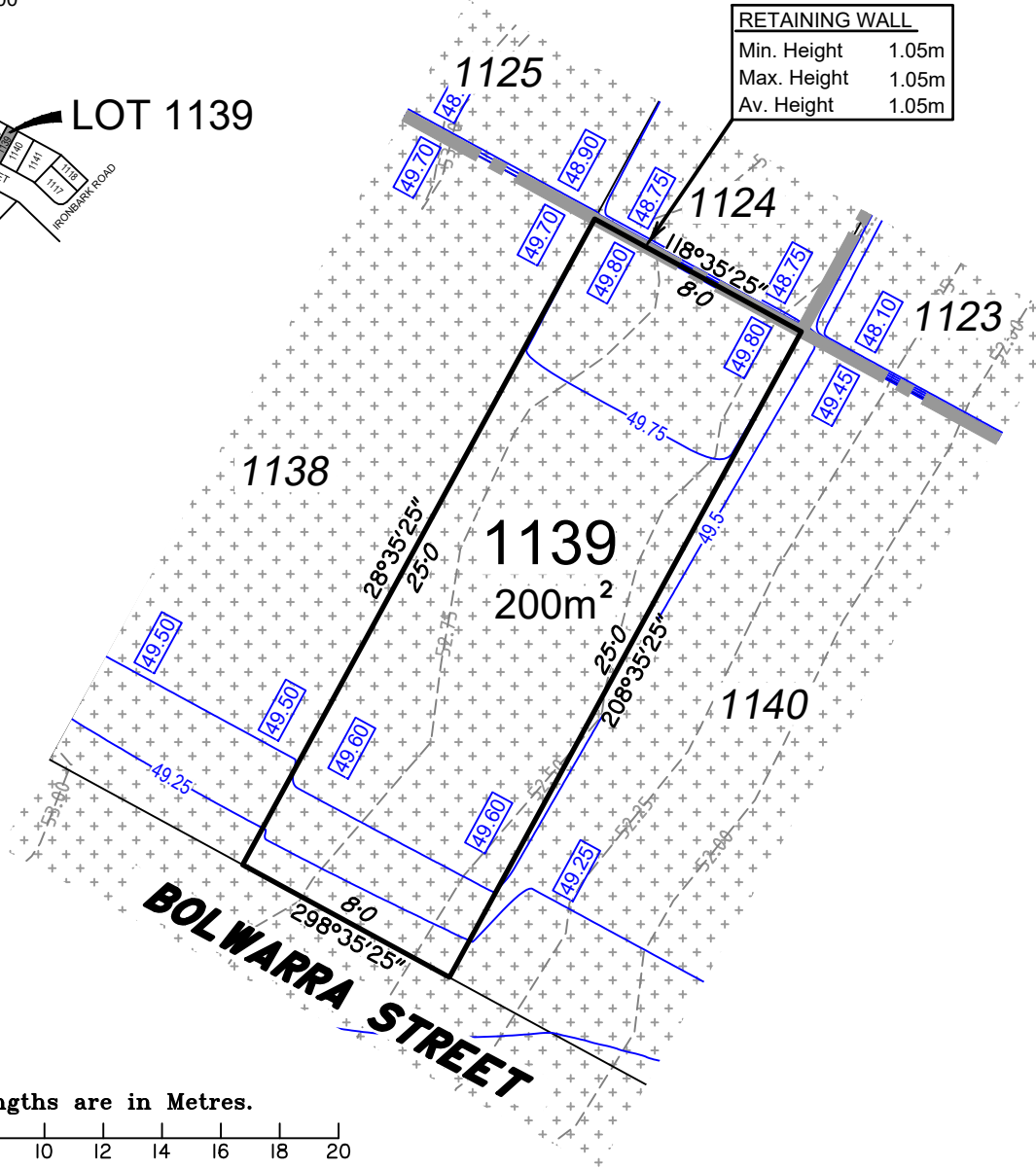

RETAINING WALL	
Min. Height	1.05m
Max. Height	1.05m
Av. Height	1.05m

Scale 1:250 - Lengths are in Metres.

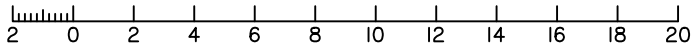

Important notes

- (1) This plan was produced for the exclusive use of SATTERLEY NARANGBA PTY LTD. It is to be used only for the purpose of Disclosure under the Land Sales Act (QLD).
- (2) This plan shows details of Proposed Allotment 1139 as described as part of Lot 3012 on SP330809 situated in the Locality of Narangba, Moreton Bay Regional.
- (3) All dimensions and areas are subject to final registration of the survey plan.
- (4) Levels shown are referenced to Australian Height Datum
- (5) Purchasers should contact the local authority to verify levels and the location of services before submitting building plans for approval.
- (6) The subject site may be affected by building envelope requirements. Purchasers should refer to the Reconfiguration of a Lot and/or Material Change of Use approvals if applicable.
- (7) Engineering design received from COLLIERS ENGINEERING & DESIGN on the 20 November 2023.
- (8) Proposed Lot Layout taken from ROL plan 18-0084-PS22 Rev J. Pending Approval by Moreton Bay Regional Council.
- (9) These notes form an integral part of this plan. If others use this information, they should be advised of its purpose and limitations.
- (10) This plan was prepared to satisfy Section 11 of the Land Sales Act QLD 1984.
- (11) Builders shall not build from the design levels shown. A site survey is required.
- (12) All fill to be compacted in accordance with A.S.3798-2007. Please refer to A.S.3798 for testing requirements.
- (13) This plan may not be reproduced unless these notes are included.

FYFE Fyfe Pty Ltd (ACN 008 116 130) hereby certify that the corporation, by John David MORROW, Cadastral Surveyor for whose work the corporation accepts responsibility, has prepared this plan.

BRISBANE
Level 3, 120 Edward Street
Brisbane QLD 4000
GPO Box 1272
Brisbane QLD 4001

T 61 7 3837 9000
www.fyfe.com.au

LEGEND:

- 13.0 Design contours - Contour Interval 0.5m (AHD)
- 13.75 Natural Surface Contours prior to earthworks - Contour Interval 0.25m (AHD)
- Retaining Wall (Design location) Indicative heights shown to wall. Heights subject to final design.
- 2.25 Depth of fill in metres shown thus
- 61.30 Design Earthworks Pad Levels
- AREAS TO BE FILLED
- AREAS TO BE CUT



DISCLOSURE PLAN
FOR PROPOSED LOT 1139
Currently described as:
Part of Lot 3012 on SP330809
Locality: NARANGBA
LGA: Moreton Bay Regional

DATE: 24/11/2023
SCALE: 1:250 @ A4

DRAWING NUMBER
49003-31_DP1139
Rev: A

LOCATION DIAGRAM

SCALE 1:5000

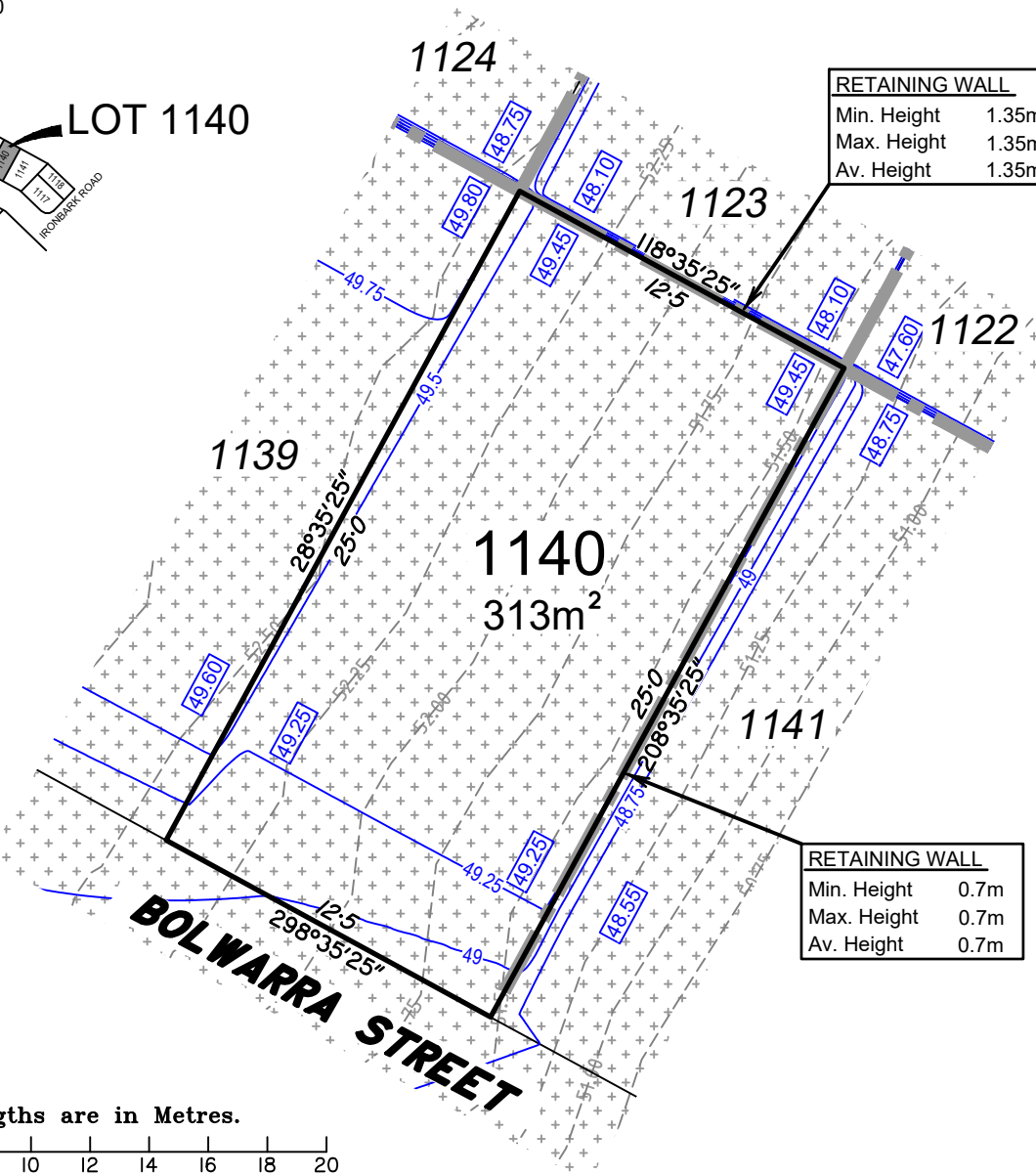
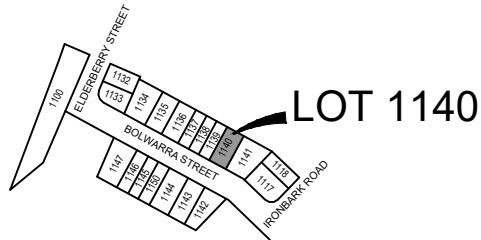

RETAINING WALL
 Min. Height 1.35m
 Max. Height 1.35m
 Av. Height 1.35m

RETAINING WALL
 Min. Height 0.7m
 Max. Height 0.7m
 Av. Height 0.7m

Scale 1:250 - Lengths are in Metres.

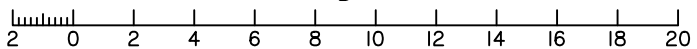

Important notes

- (1) This plan was produced for the exclusive use of SATTERLEY NARANGBA PTY LTD. It is to be used only for the purpose of Disclosure under the Land Sales Act (QLD).
- (2) This plan shows details of Proposed Allotment 1140 as described as part of Lot 3012 on SP330809 situated in the Locality of Narangba, Moreton Bay Regional.
- (3) All dimensions and areas are subject to final registration of the survey plan.
- (4) Levels shown are referenced to Australian Height Datum
- (5) Purchasers should contact the local authority to verify levels and the location of services before submitting building plans for approval.
- (6) The subject site may be affected by building envelope requirements. Purchasers should refer to the Reconfiguration of a Lot and/or Material Change of Use approvals if applicable.
- (7) Engineering design received from COLLIERS ENGINEERING & DESIGN on the 20 November 2023.
- (8) Proposed Lot Layout taken from ROL plan 18-0084-PS22 Rev J. Pending Approval by Moreton Bay Regional Council.
- (9) These notes form an integral part of this plan. If others use this information, they should be advised of its purpose and limitations.
- (10) This plan was prepared to satisfy Section 11 of the Land Sales Act QLD 1984.
- (11) Builders shall not build from the design levels shown. A site survey is required.
- (12) All fill to be compacted in accordance with A.S.3798-2007. Please refer to A.S.3798 for testing requirements.
- (13) This plan may not be reproduced unless these notes are included.

FYFE Fyfe Pty Ltd (ACN 008 116 130) hereby certify that the corporation, by John David MORROW, Cadastral Surveyor for whose work the corporation accepts responsibility, has prepared this plan.

BRISBANE
 Level 3, 120 Edward Street
 Brisbane QLD 4000
 GPO Box 1272
 Brisbane QLD 4001

T 61 7 3837 9000
 www.fyfe.com.au

LEGEND:

- 13.0 Design contours
 - Contour Interval 0.5m (AHD)
- 13.75 Natural Surface Contours prior to earthworks
 - Contour Interval 0.25m (AHD)
- Retaining Wall (Design location)
 Indicative heights shown to wall.
 Heights subject to final design.
- 2.25 Depth of fill in metres shown thus
- 61.30 Design Earthworks Pad Levels
- AREAS TO BE FILLED
- AREAS TO BE CUT



DISCLOSURE PLAN
 FOR PROPOSED LOT 1140
 Currently described as:
 Part of Lot 3012 on SP330809
 Locality: NARANGBA
 LGA: Moreton Bay Regional

DATE: 24/11/2023
 SCALE: 1:250 @ A4

DRAWING NUMBER
49003-31_DP1140
 Rev: A

LOCATION DIAGRAM

SCALE 1:5000

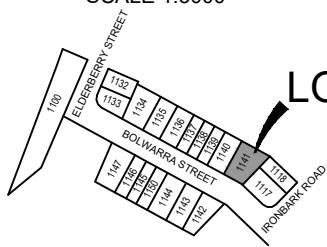

LOT 1141

RETAINING WALL	
Min. Height	0.7m
Max. Height	0.7m
Av. Height	0.7m

RETAINING WALL	
Min. Height	1.15m
Max. Height	1.15m
Av. Height	1.15m

RETAINING WALL	
Min. Height	2.0m
Max. Height	2.0m
Av. Height	2.0m

RETAINING WALL	
Min. Height	1.15m
Max. Height	1.15m
Av. Height	1.15m

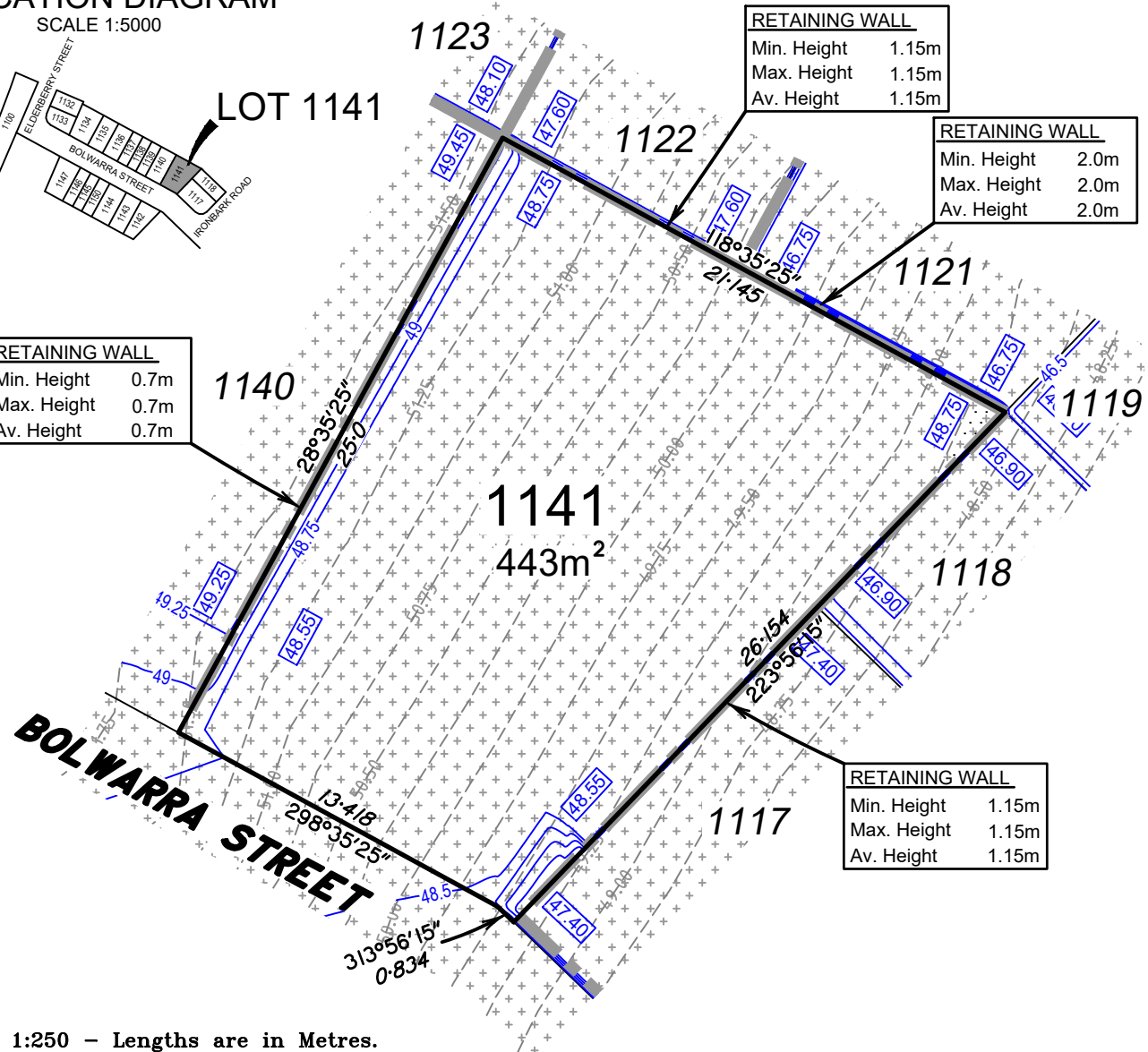

Scale 1:250 - Lengths are in Metres.

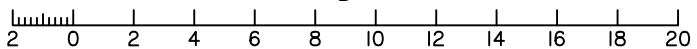

Important notes

- (1) This plan was produced for the exclusive use of SATTERLEY NARANGBA PTY LTD. It is to be used only for the purpose of Disclosure under the Land Sales Act (QLD).
- (2) This plan shows details of Proposed Allotment 1141 as described as part of Lot 3012 on SP330809 situated in the Locality of Narangba, Moreton Bay Regional.
- (3) All dimensions and areas are subject to final registration of the survey plan.
- (4) Levels shown are referenced to Australian Height Datum
- (5) Purchasers should contact the local authority to verify levels and the location of services before submitting building plans for approval.
- (6) The subject site may be affected by building envelope requirements. Purchasers should refer to the Reconfiguration of a Lot and/or Material Change of Use approvals if applicable.
- (7) Engineering design received from COLLIERS ENGINEERING & DESIGN on the 20 November 2023.
- (8) Proposed Lot Layout taken from ROL plan 18-0084-PS22 Rev J. Pending Approval by Moreton Bay Regional Council.
- (9) These notes form an integral part of this plan. If others use this information, they should be advised of its purpose and limitations.
- (10) This plan was prepared to satisfy Section 11 of the Land Sales Act QLD 1984.
- (11) Builders shall not build from the design levels shown. A site survey is required.
- (12) All fill to be compacted in accordance with A.S.3798-2007. Please refer to A.S.3798 for testing requirements.
- (13) This plan may not be reproduced unless these notes are included.



BRISBANE
Level 3, 120 Edward Street
Brisbane QLD 4000
GPO Box 1272
Brisbane QLD 4001

T 61 7 3837 9000
www.fyfe.com.au

Fyfe Pty Ltd (ACN 008 116 130) hereby certify that the corporation, by John David MORROW, Cadastral Surveyor for whose work the corporation accepts responsibility, has prepared this plan.

LEGEND:

- Design contours
- Contour Interval 0.5m (AHD)
- Natural Surface Contours prior to earthworks
- Contour Interval 0.25m (AHD)
- Retaining Wall (Design location)
Indicative heights shown to wall.
Heights subject to final design.
- Depth of fill in metres shown thus
- Design Earthworks Pad Levels
- AREAS TO BE FILLED
- AREAS TO BE CUT



DISCLOSURE PLAN
FOR PROPOSED LOT 1141
Currently described as:
Part of Lot 3012 on SP330809
Locality: NARANGBA
LGA: Moreton Bay Regional

DATE: 24/11/2023
SCALE: 1:250 @ A4

DRAWING NUMBER
49003-31_DP1141
Rev: A

LOCATION DIAGRAM

SCALE 1:5000

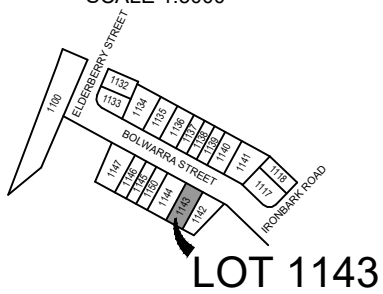

LOT 1143

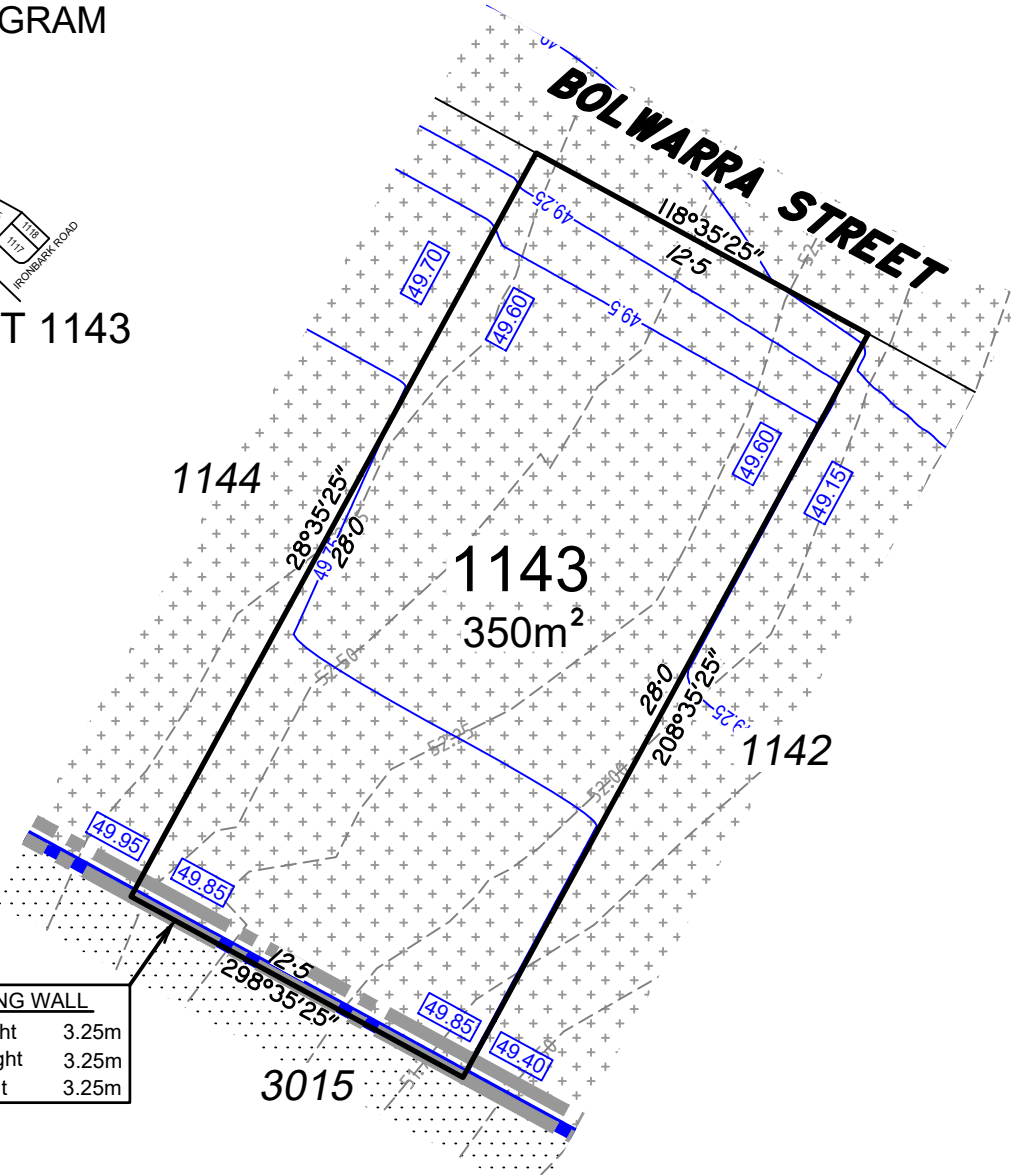

RETAINING WALL	
Min. Height	3.25m
Max. Height	3.25m
Av. Height	3.25m

Scale 1:250 - Lengths are in Metres.

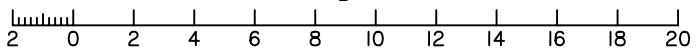

Important notes

- (1) This plan was produced for the exclusive use of SATTERLEY NARANGBA PTY LTD. It is to be used only for the purpose of Disclosure under the Land Sales Act (QLD).
- (2) This plan shows details of Proposed Allotment 1143 as described as part of Lot 3012 on SP330809 situated in the Locality of Narangba, Moreton Bay Regional.
- (3) All dimensions and areas are subject to final registration of the survey plan.
- (4) Levels shown are referenced to Australian Height Datum
- (5) Purchasers should contact the local authority to verify levels and the location of services before submitting building plans for approval.
- (6) The subject site may be affected by building envelope requirements. Purchasers should refer to the Reconfiguration of a Lot and/or Material Change of Use approvals if applicable.
- (7) Engineering design received from COLLIERS ENGINEERING & DESIGN on the 20 November 2023.
- (8) Proposed Lot Layout taken from ROL plan 18-0084-PS22 Rev J. Pending Approval by Moreton Bay Regional Council.
- (9) These notes form an integral part of this plan. If others use this information, they should be advised of its purpose and limitations.
- (10) This plan was prepared to satisfy Section 11 of the Land Sales Act QLD 1984.
- (11) Builders shall not build from the design levels shown. A site survey is required.
- (12) All fill to be compacted in accordance with A.S.3798-2007. Please refer to A.S.3798 for testing requirements.
- (13) This plan may not be reproduced unless these notes are included.



BRISBANE
Level 3, 120 Edward Street
Brisbane QLD 4000
GPO Box 1272
Brisbane QLD 4001

T 61 7 3837 9000
www.fyfe.com.au

Fyfe Pty Ltd (ACN 008 116 130) hereby certify that the corporation, by John David MORROW, Cadastral Surveyor for whose work the corporation accepts responsibility, has prepared this plan.

LEGEND:

- 13.0 — Design contours
— Contour Interval 0.5m (AHD)
- 13.75 — Natural Surface Contours prior to earthworks
— Contour Interval 0.25m (AHD)
- Retaining Wall (Design location)
Indicative heights shown to wall.
Heights subject to final design.
- 2.25 Depth of fill in metres shown thus
- 61.30 Design Earthworks Pad Levels
- + + + AREAS TO BE FILLED
- + + + AREAS TO BE CUT



DISCLOSURE PLAN
FOR PROPOSED LOT 1143
Currently described as:
Part of Lot 3012 on SP330809
Locality: NARANGBA
LGA: Moreton Bay Regional

DATE: 24/11/2023
SCALE: 1:250 @ A4

DRAWING NUMBER
49003-31_DP1143
Rev: A

LOCATION DIAGRAM

SCALE 1:5000

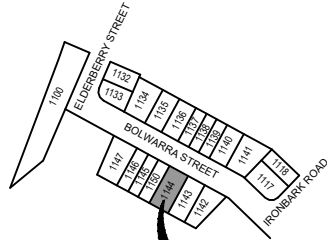

LOT 1144

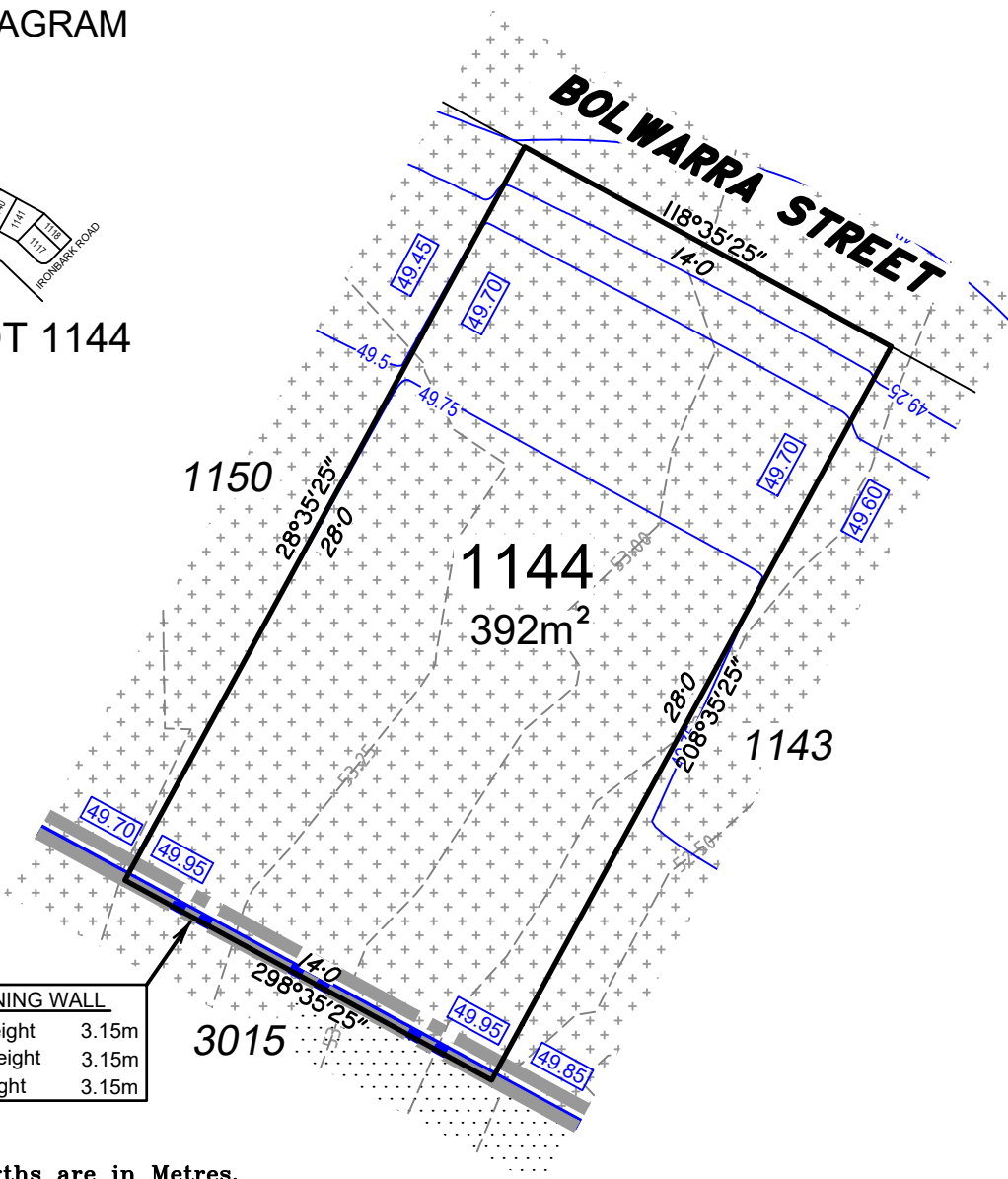

RETAINING WALL	
Min. Height	3.15m
Max. Height	3.15m
Av. Height	3.15m

Scale 1:250 - Lengths are in Metres.

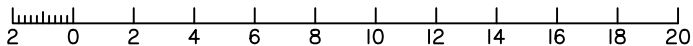

Important notes

- (1) This plan was produced for the exclusive use of SATTERLEY NARANGBA PTY LTD. It is to be used only for the purpose of Disclosure under the Land Sales Act (QLD).
- (2) This plan shows details of Proposed Allotment 1144 as described as part of Lot 3012 on SP330809 situated in the Locality of Narangba, Moreton Bay Regional.
- (3) All dimensions and areas are subject to final registration of the survey plan.
- (4) Levels shown are referenced to Australian Height Datum
- (5) Purchasers should contact the local authority to verify levels and the location of services before submitting building plans for approval.
- (6) The subject site may be affected by building envelope requirements. Purchasers should refer to the Reconfiguration of a Lot and/or Material Change of Use approvals if applicable.
- (7) Engineering design received from COLLIERS ENGINEERING & DESIGN on the 20 November 2023.
- (8) Proposed Lot Layout taken from ROL plan 18-0084-PS22 Rev J. Pending Approval by Moreton Bay Regional Council.
- (9) These notes form an integral part of this plan. If others use this information, they should be advised of its purpose and limitations.
- (10) This plan was prepared to satisfy Section 11 of the Land Sales Act QLD 1984.
- (11) Builders shall not build from the design levels shown. A site survey is required.
- (12) All fill to be compacted in accordance with A.S.3798-2007. Please refer to A.S.3798 for testing requirements.
- (13) This plan may not be reproduced unless these notes are included.



BRISBANE
Level 3, 120 Edward Street
Brisbane QLD 4000
GPO Box 1272
Brisbane QLD 4001

T 61 7 3837 9000
www.fyfe.com.au

Fyfe Pty Ltd (ACN 008 116 130) hereby certify that the corporation, by John David MORROW, Cadastral Surveyor for whose work the corporation accepts responsibility, has prepared this plan.

LEGEND:

- 13.0 — Design contours
— Contour Interval 0.5m (AHD)
- 13.75 — Natural Surface Contours prior to earthworks
— Contour Interval 0.25m (AHD)
- ▬▬▬ Retaining Wall (Design location)
Indicative heights shown to wall.
Heights subject to final design.
- 2.25 Depth of fill in metres shown thus
- 61.30 Design Earthworks Pad Levels
- AREAS TO BE FILLED
- + AREAS TO BE CUT



DISCLOSURE PLAN
FOR PROPOSED LOT 1144
Currently described as:
Part of Lot 3012 on SP330809
Locality: NARANGBA
LGA: Moreton Bay Regional

DATE: 24/11/2023
SCALE: 1:250 @ A4

DRAWING NUMBER
49003-31_DP1144
Rev: A

LOCATION DIAGRAM

SCALE 1:5000

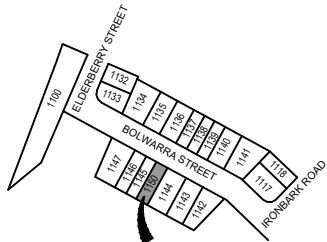

LOT 1150

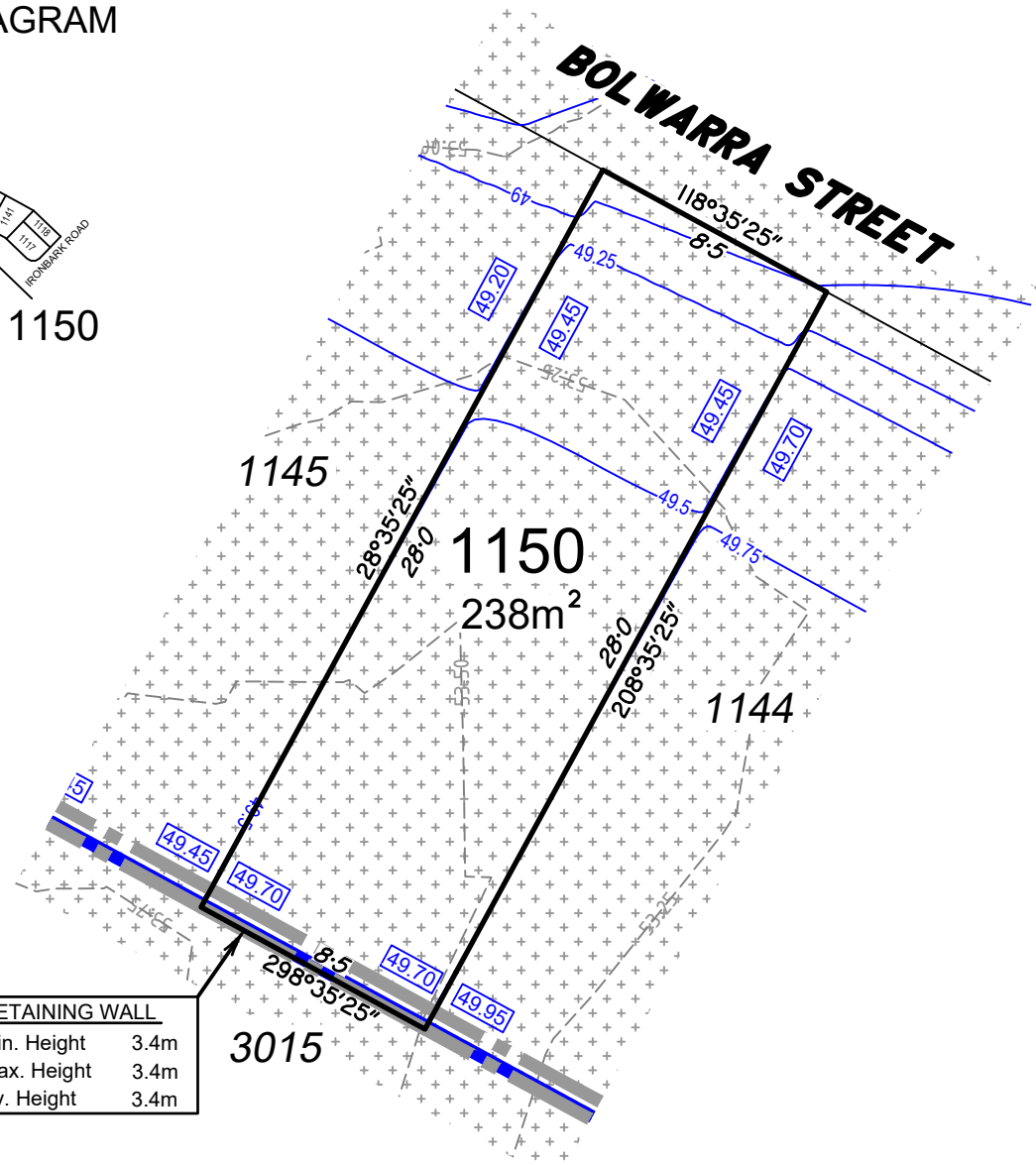

RETAINING WALL	
Min. Height	3.4m
Max. Height	3.4m
Av. Height	3.4m

Scale 1:250 - Lengths are in Metres.

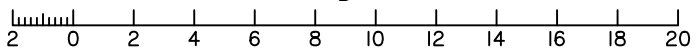

Important notes

- (1) This plan was produced for the exclusive use of SATTERLEY NARANGBA PTY LTD. It is to be used only for the purpose of Disclosure under the Land Sales Act (QLD).
- (2) This plan shows details of Proposed Allotment 1150 as described as part of Lot 3012 on SP330809 situated in the Locality of Narangba, Moreton Bay Regional.
- (3) All dimensions and areas are subject to final registration of the survey plan.
- (4) Levels shown are referenced to Australian Height Datum
- (5) Purchasers should contact the local authority to verify levels and the location of services before submitting building plans for approval.
- (6) The subject site may be affected by building envelope requirements. Purchasers should refer to the Reconfiguration of a Lot and/or Material Change of Use approvals if applicable.
- (7) Engineering design received from COLLIERS ENGINEERING & DESIGN on the 20 November 2023.
- (8) Proposed Lot Layout taken from ROL plan 18-0084-PS22 Rev J. Pending Approval by Moreton Bay Regional Council.
- (9) These notes form an integral part of this plan. If others use this information, they should be advised of its purpose and limitations.
- (10) This plan was prepared to satisfy Section 11 of the Land Sales Act QLD 1984.
- (11) Builders shall not build from the design levels shown. A site survey is required.
- (12) All fill to be compacted in accordance with A.S.3798-2007. Please refer to A.S.3798 for testing requirements.
- (13) This plan may not be reproduced unless these notes are included.

Fyfe Pty Ltd (ACN 008 116 130) hereby certify that the corporation, by John David MORROW, Cadastral Surveyor for whose work the corporation accepts responsibility, has prepared this plan.

BRISBANE
Level 3, 120 Edward Street
Brisbane QLD 4000
GPO Box 1272
Brisbane QLD 4001

T 61 7 3837 9000
www.fyfe.com.au

LEGEND:

- 13.0 — Design contours
— Contour Interval 0.5m (AHD)
- 13.75 — Natural Surface Contours prior to earthworks
— Contour Interval 0.25m (AHD)
- Retaining Wall (Design location)
Indicative heights shown to wall.
Heights subject to final design.
- 2.25 Depth of fill in metres shown thus
- 61.30 Design Earthworks Pad Levels
- AREAS TO BE FILLED
- AREAS TO BE CUT



DISCLOSURE PLAN
FOR PROPOSED LOT 1150
Currently described as:
Part of Lot 3012 on SP330809
Locality: NARANGBA
LGA: Moreton Bay Regional

DATE: 24/11/2023
SCALE: 1:250 @ A4

DRAWING NUMBER
49003-31_DP1150
Rev: A

LOCATION DIAGRAM

SCALE 1:5000

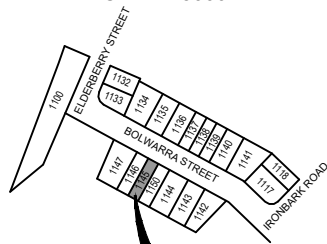

LOT 1145

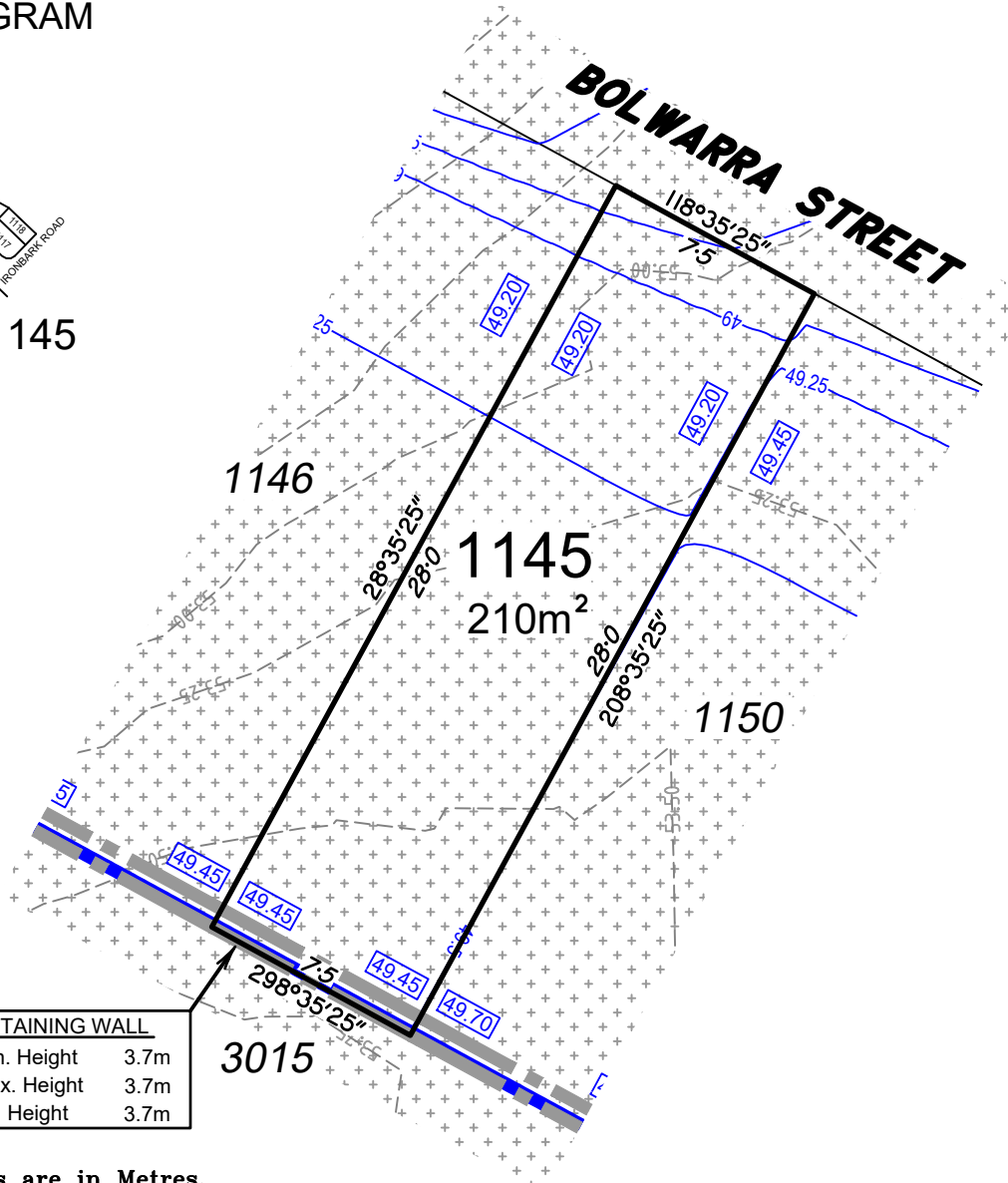

RETAINING WALL	
Min. Height	3.7m
Max. Height	3.7m
Av. Height	3.7m

Scale 1:250 - Lengths are in Metres.

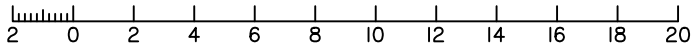

Important notes

- (1) This plan was produced for the exclusive use of SATTERLEY NARANGBA PTY LTD. It is to be used only for the purpose of Disclosure under the Land Sales Act (QLD).
- (2) This plan shows details of Proposed Allotment 1145 as described as part of Lot 3012 on SP330809 situated in the Locality of Narangba, Moreton Bay Regional.
- (3) All dimensions and areas are subject to final registration of the survey plan.
- (4) Levels shown are referenced to Australian Height Datum
- (5) Purchasers should contact the local authority to verify levels and the location of services before submitting building plans for approval.
- (6) The subject site may be affected by building envelope requirements. Purchasers should refer to the Reconfiguration of a Lot and/or Material Change of Use approvals if applicable.
- (7) Engineering design received from COLLIERS ENGINEERING & DESIGN on the 20 November 2023.
- (8) Proposed Lot Layout taken from ROL plan 18-0084-PS22 Rev J. Pending Approval by Moreton Bay Regional Council.
- (9) These notes form an integral part of this plan. If others use this information, they should be advised of its purpose and limitations.
- (10) This plan was prepared to satisfy Section 11 of the Land Sales Act QLD 1984.
- (11) Builders shall not build from the design levels shown. A site survey is required.
- (12) All fill to be compacted in accordance with A.S.3798-2007. Please refer to A.S.3798 for testing requirements.
- (13) This plan may not be reproduced unless these notes are included.



BRISBANE
Level 3, 120 Edward Street
Brisbane QLD 4000
GPO Box 1272
Brisbane QLD 4001

T 61 7 3837 9000
www.fyfe.com.au

Fyfe Pty Ltd (ACN 008 116 130) hereby certify that the corporation, by John David MORROW, Cadastral Surveyor for whose work the corporation accepts responsibility, has prepared this plan.

LEGEND:

- 13.0 — Design contours
— Contour Interval 0.5m (AHD)
- 13.75 — Natural Surface Contours prior to earthworks
— Contour Interval 0.25m (AHD)
- ▬▬▬ Retaining Wall (Design location)
Indicative heights shown to wall.
Heights subject to final design.
- 2.25 Depth of fill in metres shown thus
- 61.30 Design Earthworks Pad Levels
- AREAS TO BE FILLED
- + + + AREAS TO BE CUT



DISCLOSURE PLAN
FOR PROPOSED LOT 1145
Currently described as:
Part of Lot 3012 on SP330809
Locality: NARANGBA
LGA: Moreton Bay Regional

DATE: 24/11/2023
SCALE: 1:250 @ A4

DRAWING NUMBER
49003-31_DP1145
Rev: A

LOCATION DIAGRAM

SCALE 1:5000

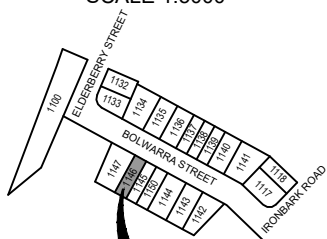

LOT 1146

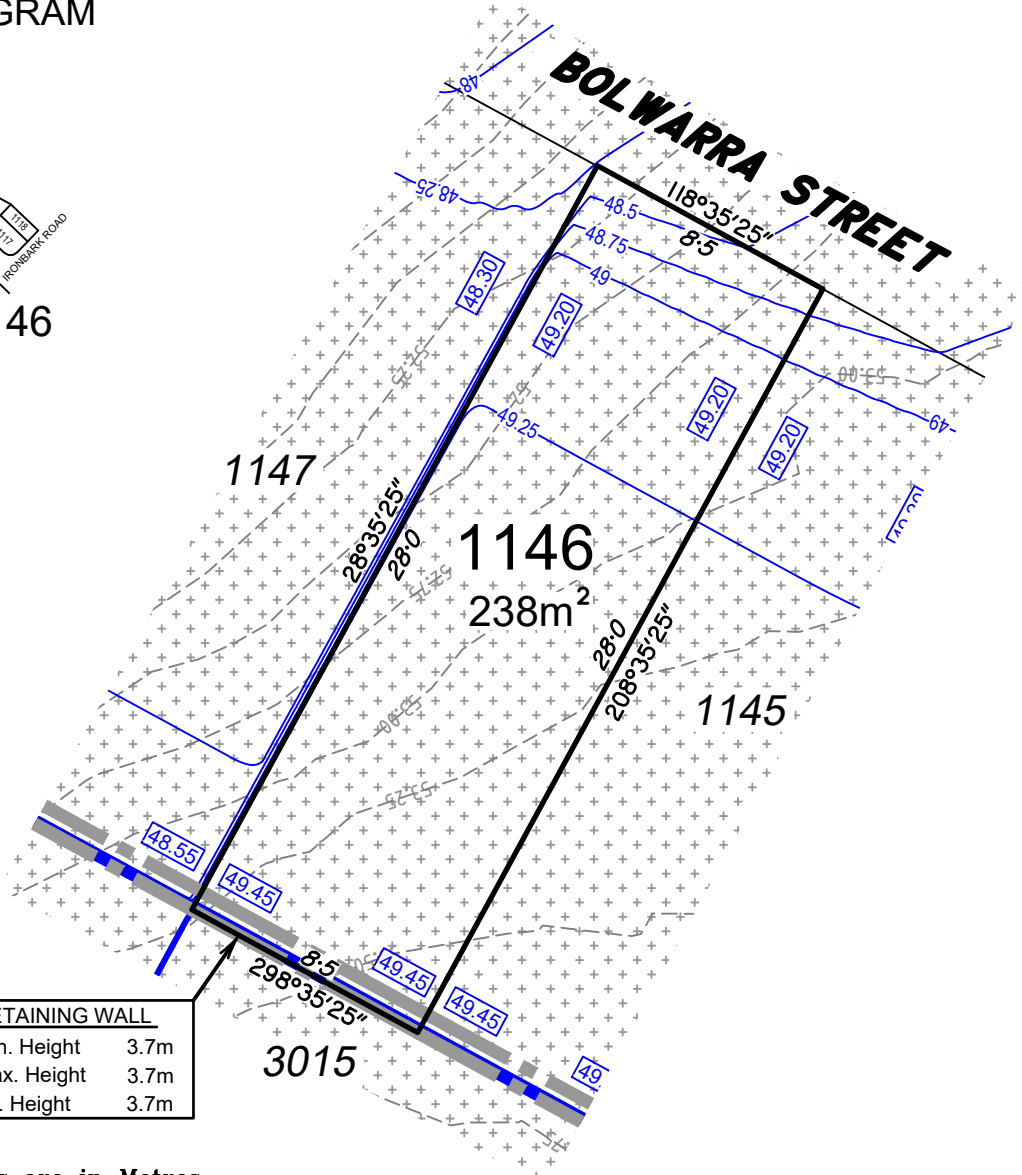

RETAINING WALL	
Min. Height	3.7m
Max. Height	3.7m
Av. Height	3.7m

Scale 1:250 - Lengths are in Metres.

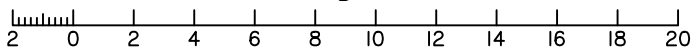

Important notes

- (1) This plan was produced for the exclusive use of SATTERLEY NARANGBA PTY LTD. It is to be used only for the purpose of Disclosure under the Land Sales Act (QLD).
- (2) This plan shows details of Proposed Allotment 1146 as described as part of Lot 3012 on SP330809 situated in the Locality of Narangba, Moreton Bay Regional.
- (3) All dimensions and areas are subject to final registration of the survey plan.
- (4) Levels shown are referenced to Australian Height Datum
- (5) Purchasers should contact the local authority to verify levels and the location of services before submitting building plans for approval.
- (6) The subject site may be affected by building envelope requirements. Purchasers should refer to the Reconfiguration of a Lot and/or Material Change of Use approvals if applicable.
- (7) Engineering design received from COLLIERS ENGINEERING & DESIGN on the 20 November 2023.
- (8) Proposed Lot Layout taken from ROL plan 18-0084-PS22 Rev J. Pending Approval by Moreton Bay Regional Council.
- (9) These notes form an integral part of this plan. If others use this information, they should be advised of its purpose and limitations.
- (10) This plan was prepared to satisfy Section 11 of the Land Sales Act QLD 1984.
- (11) Builders shall not build from the design levels shown. A site survey is required.
- (12) All fill to be compacted in accordance with A.S.3798-2007. Please refer to A.S.3798 for testing requirements.
- (13) This plan may not be reproduced unless these notes are included.



BRISBANE
Level 3, 120 Edward Street
Brisbane QLD 4000
GPO Box 1272
Brisbane QLD 4001

T 61 7 3837 9000
www.fyfe.com.au

Fyfe Pty Ltd (ACN 008 116 130) hereby certify that the corporation, by John David MORROW, Cadastral Surveyor for whose work the corporation accepts responsibility, has prepared this plan.

LEGEND:

- 13.0 — Design contours
— Contour Interval 0.5m (AHD)
- 13.75 — Natural Surface Contours prior to earthworks
— Contour Interval 0.25m (AHD)
- ▬▬▬ Retaining Wall (Design location)
Indicative heights shown to wall.
Heights subject to final design.
- 2.25 Depth of fill in metres shown thus
- 61.30 Design Earthworks Pad Levels
- AREAS TO BE FILLED
- + + + AREAS TO BE CUT



DISCLOSURE PLAN
FOR PROPOSED LOT 1146
Currently described as:
Part of Lot 3012 on SP330809
Locality: NARANGBA
LGA: Moreton Bay Regional

DATE: 24/11/2023
SCALE: 1:250 @ A4

DRAWING NUMBER
49003-31_DP1146
Rev: A

LOCATION DIAGRAM

SCALE 1:5000

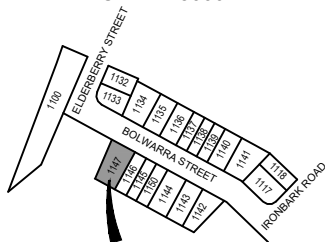

LOT 1147

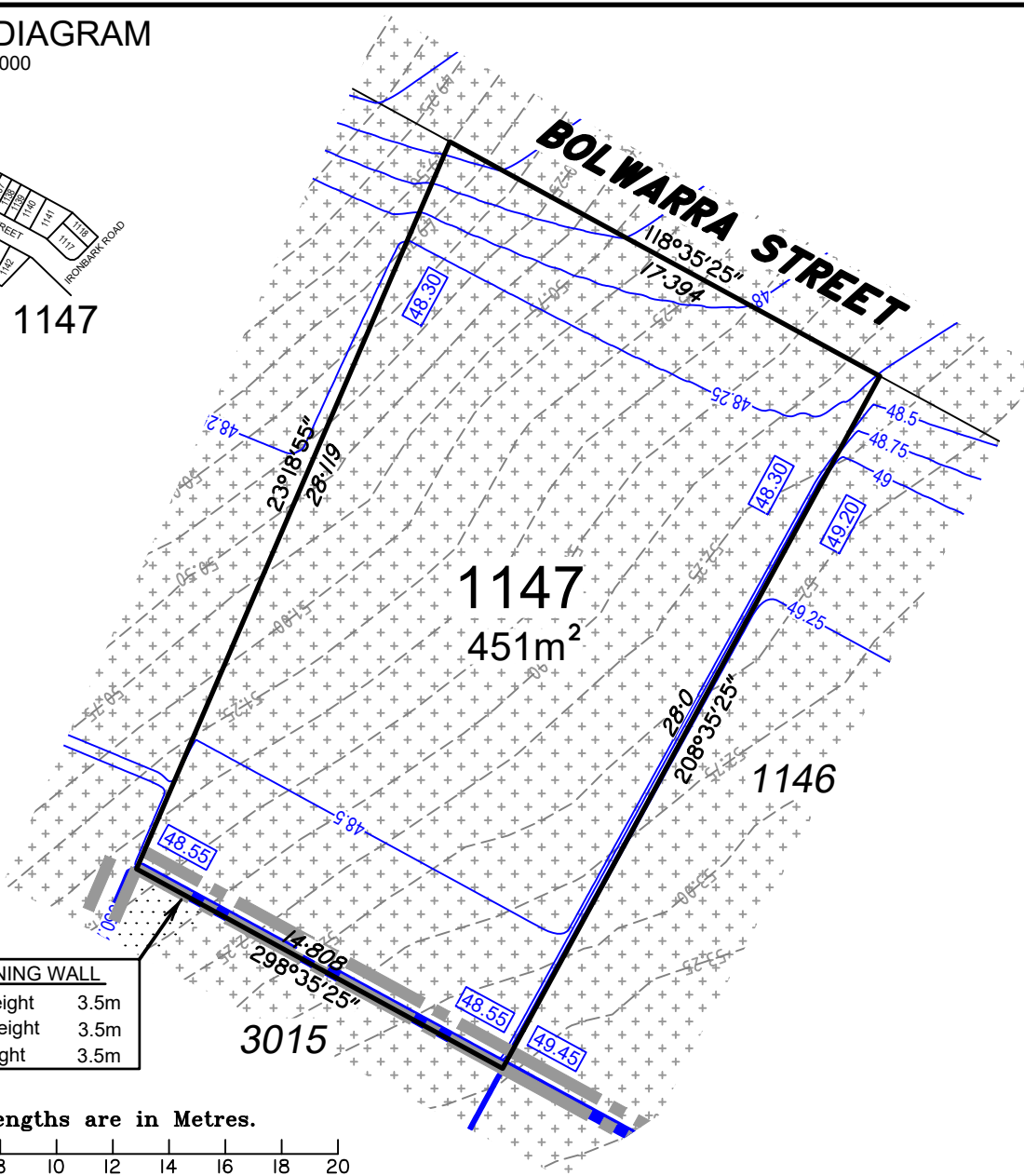

RETAINING WALL	
Min. Height	3.5m
Max. Height	3.5m
Av. Height	3.5m

Scale 1:250 - Lengths are in Metres.

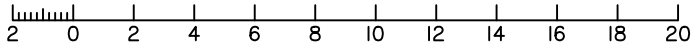

Important notes

- (1) This plan was produced for the exclusive use of SATTERLEY NARANGBA PTY LTD. It is to be used only for the purpose of Disclosure under the Land Sales Act (QLD).
- (2) This plan shows details of Proposed Allotment 1147 as described as part of Lot 3012 on SP330809 situated in the Locality of Narangba, Moreton Bay Regional.
- (3) All dimensions and areas are subject to final registration of the survey plan.
- (4) Levels shown are referenced to Australian Height Datum
- (5) Purchasers should contact the local authority to verify levels and the location of services before submitting building plans for approval.
- (6) The subject site may be affected by building envelope requirements. Purchasers should refer to the Reconfiguration of a Lot and/or Material Change of Use approvals if applicable.
- (7) Engineering design received from COLLIERS ENGINEERING & DESIGN on the 20 November 2023.
- (8) Proposed Lot Layout taken from ROL plan 18-0084-PS22 Rev J. Pending Approval by Moreton Bay Regional Council.
- (9) These notes form an integral part of this plan. If others use this information, they should be advised of its purpose and limitations.
- (10) This plan was prepared to satisfy Section 11 of the Land Sales Act QLD 1984.
- (11) Builders shall not build from the design levels shown. A site survey is required.
- (12) All fill to be compacted in accordance with A.S.3798-2007. Please refer to A.S.3798 for testing requirements.
- (13) This plan may not be reproduced unless these notes are included.



BRISBANE
Level 3, 120 Edward Street
Brisbane QLD 4000
GPO Box 1272
Brisbane QLD 4001

T 61 7 3837 9000
www.fyfe.com.au

Fyfe Pty Ltd (ACN 008 116 130) hereby certify that the corporation, by John David MORROW, Cadastral Surveyor for whose work the corporation accepts responsibility, has prepared this plan.

LEGEND:

- 13.0 Design contours
- Contour Interval 0.5m (AHD)
- 13.75 Natural Surface Contours prior to earthworks
- Contour Interval 0.25m (AHD)
- Retaining Wall (Design location)
Indicative heights shown to wall.
Heights subject to final design.
- 2.25 Depth of fill in metres shown thus
- 61.30 Design Earthworks Pad Levels
- AREAS TO BE FILLED
- AREAS TO BE CUT



DISCLOSURE PLAN
FOR PROPOSED LOT 1147
Currently described as:
Part of Lot 3012 on SP330809
Locality: NARANGBA
LGA: Moreton Bay Regional

DATE: 24/11/2023
SCALE: 1:250 @ A4

DRAWING NUMBER
49003-31_DP1147
Rev: A