

Huggins Road

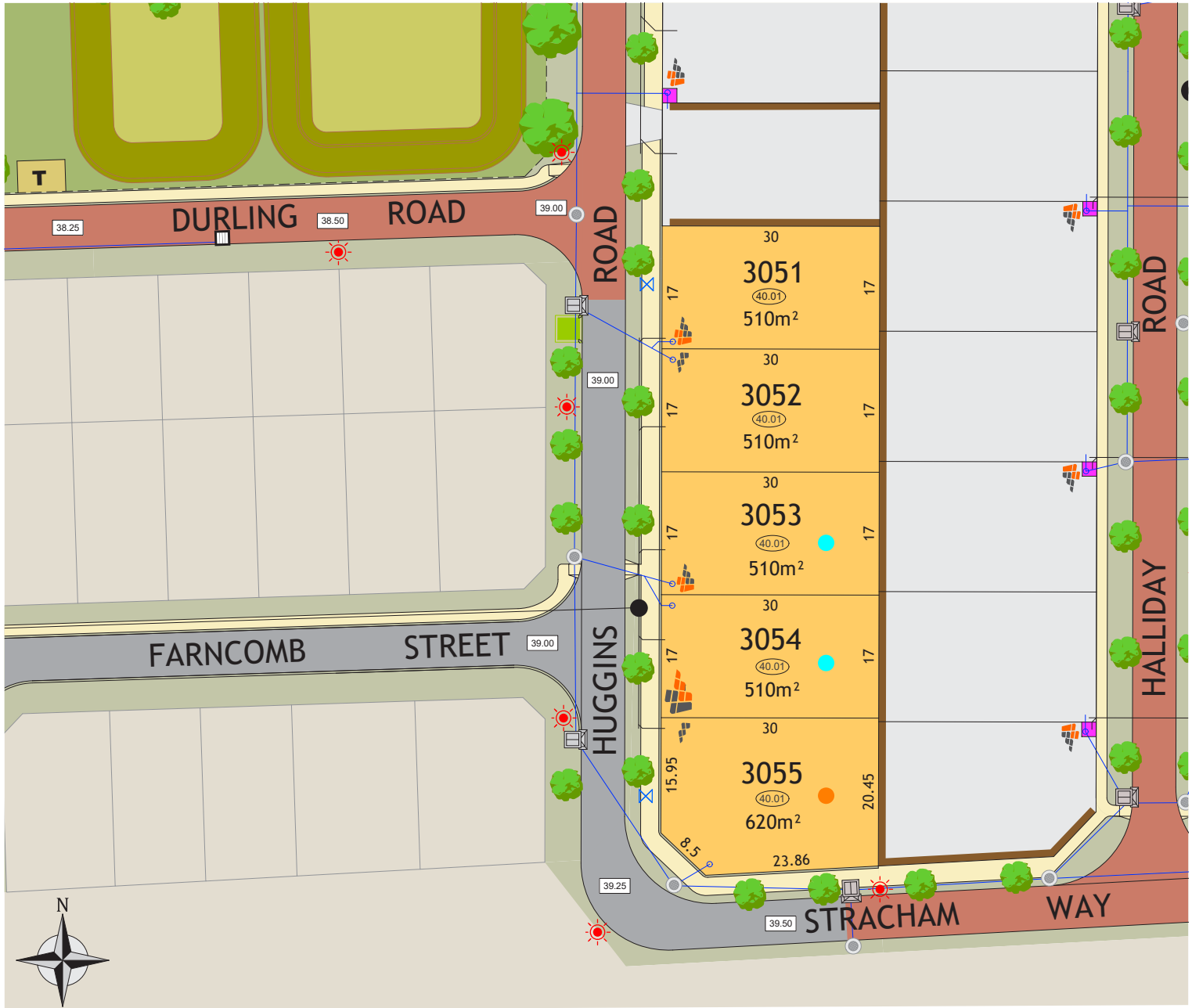

Preliminary

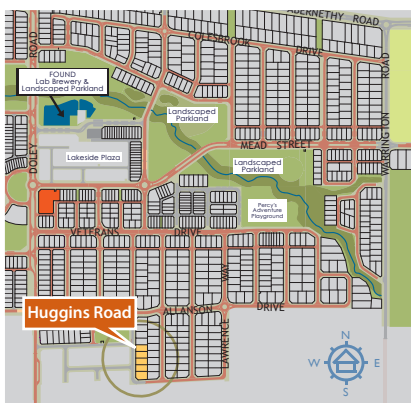

Huggins Road	Existing Residential	Land by Others
--------------	----------------------	----------------

LEGEND		
Red Asphalt	Drainage Grate	Western Power Mini Pillar & Connection
Brick Paving	Side Entry Pit	Western Power Uni Pillar & Connection
Footpath	Drainage Manhole	Western Power Padmount Site
Road Level	Stormwater Junction Connection	Street Lights
	Sewer Housing Connection /Manhole	Water Hydrant
	Limestone Retaining Wall	Water Valve
	Indicative Tree	Bushfire Attack Level
	Lot Level	BAL - 12.5
		BAL - 19

Note 1 : Lots abutting laneways may be subject to a 1m x 1m Light Pole easement or road widening.

Note 2: This plan is indicative only and may be subject to change. All dimensions and areas are subject to survey. The particulars on this brochure are supplied for identification purposes only and shall not be taken as a representation in any respect on the part of the vendor or it's agents. Authorities should be consulted when services are contained within lot boundaries as building restrictions may apply. Some services may not be shown, as engineering design is still to be finalised.

Note 3: Street Names preliminary and subject to change

Note 4: Selected existing trees to remain.

All Engineering, Electrical, Cadastral & Encumbrances are still to be designed and are subject to change.