



## The Jade

From \$642,900\*



3



2



2

Area: 315m<sup>2</sup> | Frontage: 10.5m



### Reece Scales

Estate Manager

0460 299 989

[mahala@satterley.com.au](mailto:mahala@satterley.com.au)

## Features

- 3.52kW PV solar panel system
- Hobless shower recess with semi frameless pivot door and screen to ensuite and bathroom
- NBN ready package with TV point, two data points and conduits
- Jason Windows quality range of sliding doors and Breezelock windows with flyscreens and one-key security locks
- Your choice of Brick veneer or Double Brick
- Westinghouse appliances to the kitchen
- Chrome, brushed nickel or matt black tapware throughout.

*\*Disclaimer on reverse*



### Lucia Vanessa

New Home Consultant

0406 117 724

[lucia@thepropertypros.com.au](mailto:lucia@thepropertypros.com.au)

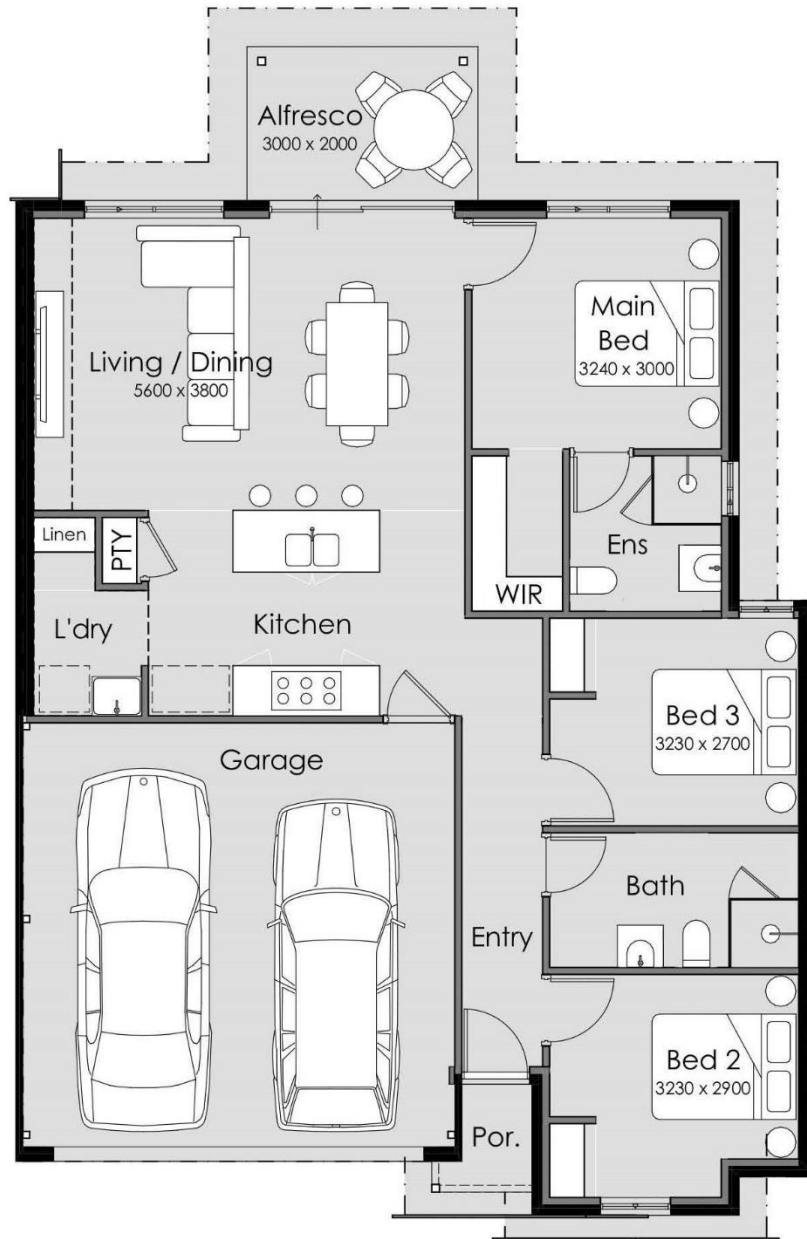

\*Disclaimer: All information for the House and Land package has been compiled for your information only. You should conduct your own enquiries as to the accuracy of the information provided. This information is not intended to constitute an offer to sell, or an invitation to purchase a property at a specified price. Whilst all information contained has been prepared with care, neither the seller nor Satterley Property Group make any representation or warranty as to the accuracy or currency of the information provided and do not accept any responsibility or liability for any errors or omissions. Satterley Property Group has permission from the home builder to advertise the home. Images and floor plans that have been shown are for illustration purposes only. Photographs and floor plans may not be truly representative of final designs. Some fixtures, features and landscaping may not be supplied. A building contract will be entered into with the Builder for the home construction and site work. A separate land contract must be entered with the landowner as the Builder does not own the land. The land price does not include transfer duty, settlement costs and any other fees or disbursements associated with the settlement of the land. The listed lot is available at the time of publishing however may be sold by the owner without notice. If this is to occur a similar sized lot may be offered, if available, and the package price will be adjusted accordingly. Satterley Property Group and the builder reserve the right to alter the home, land and site work prices. The house design may need to vary to comply with design guidelines, DAPs, estate covenants and any other requirements of the lot. Any costs for these changes will be paid for by the purchaser. Please speak to a Satterley Property Group Estate Manager for questions and further information.

Correct as at 8/1/2025.



**From \$642,900\***