

REGISTERED SURVEYOR'S CERTIFICATION

I, _____ hereby certify that the vertical and horizontal locations and dimensions shown on this plan are a true and correct record and were located by survey.

Registered Surveyor (QLD) (sig.) Reg. Surveyor No. _____ Date: _____

AS CONSTRUCTED CERTIFICATION

I, _____ (Company's representative Name) (Signature)
 _____ (Date) (RPEQ)
 Being a duly representative of - _____ (Company Name)

Hereby certify that
 1. The information contained in this drawing / document is in compliance with approved drawings and design supplied under the terms of the contract.
 2. This represents an accurate "As constructed" record of works carried out and accept responsibility for the information contained in this drawing / document.

LEGEND

- LIP-IN-LINE GULLY PIT
- FIELD INLET
- PRAM RAMP
- TRAFFIC CONTROL SIGN
- DRAINAGE PIPE
- EXISTING DRAINAGE PIPE
- PATHWAY
- EDGE OF PAVEMENT
- BARRIER KERB AND CHANNEL - B1 (IPWEAQ RS-080)
- MOUNTABLE KERB AND CHANNEL - M1 (IPWEAQ RS-080)

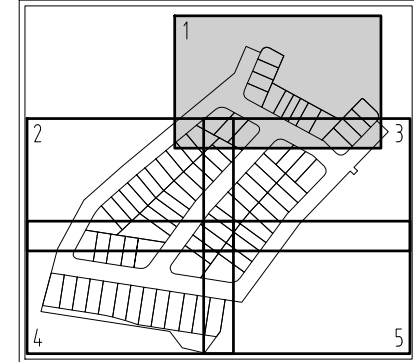

KEYPLAN N.T.S.

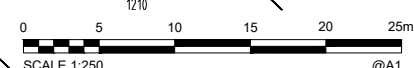
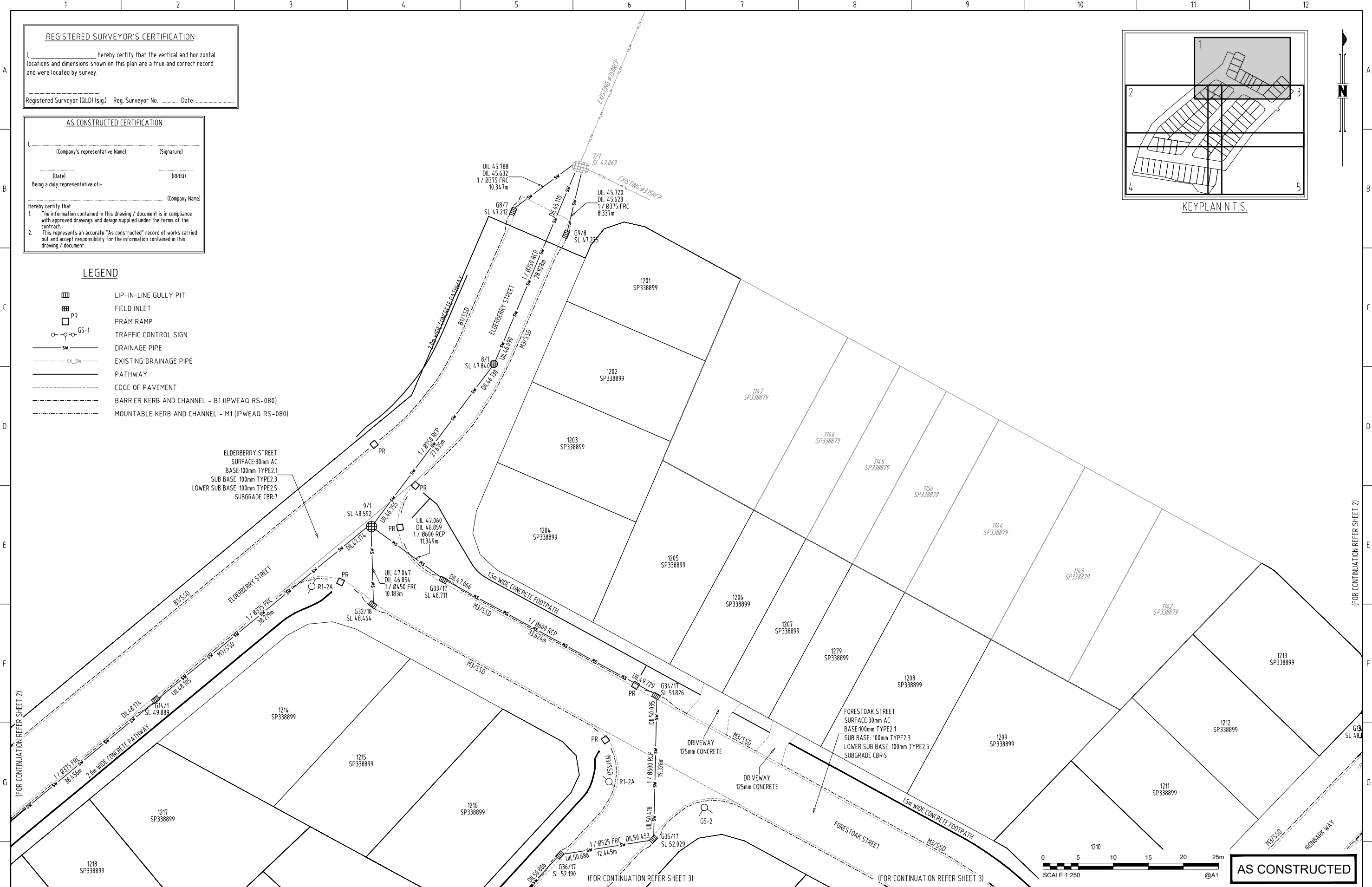

AS CONSTRUCTED

DRAWING REVISIONS		REFERENCE DRAWINGS		DESIGN FILE No.	DESIGNED
REV.	REVISION DESCRIPTION	DRG. No.	DESCRIPTION	CONSTRUCT. No.	DATE
0	AS-CONSTRUCTED DRAWINGS				

THIS WORK WAS PREPARED BY:

Lion Systems on behalf of SHADFORTH

DESIGNED	DATE	10/07/2025
DRAWN	RMP	
CHECKED	DL	
DATE	10/07/2025	

SCALE 1:250 ORIGINAL SIZE A1

MORETON BAY REGIONAL COUNCIL
 PINE DISTRICT OFFICE
 220 GYMPIE ROAD STRATHPINE QLD 4500
 PO BOX 159 CABOOLTURE QLD 4510
 Telephone: (07) 3480 8666
 Fax: (07) 3480 8710

ROADS AND DRAINAGE
AS CONSTRUCTED
RIDGEVIEW - STAGE 12A, 12B, 12C
RAYNBIRD ROAD, NARANGBA

MBRC SUBDIVISION REFERENCE	
DA/2024/2801	
No. 1 OF 5 PLANS	
ASCON GRID NUMBER	REV.
	0

REGISTERED SURVEYOR'S CERTIFICATION

I, _____ hereby certify that the vertical and horizontal locations and dimensions shown on this plan are a true and correct record and were located by survey.

Registered Surveyor (QLD) (sig) Reg. Surveyor No. _____ Date: _____

AS CONSTRUCTED CERTIFICATION

I, _____ (Company's representative Name) _____ (Signature)

(Date) _____ (RPEQ)

Being a duly representative of - _____ (Company Name)

Hereby certify that
 1. The information contained in this drawing / document is in compliance with approved drawings and design supplied under the terms of the contract.
 2. This represents an accurate "As constructed" record of works carried out and accept responsibility for the information contained in this drawing / document.

LEGEND

- LIP-IN-LINE GULLY PIT
- FIELD INLET
- PRAM RAMP
- TRAFFIC CONTROL SIGN
- DRAINAGE PIPE
- EXISTING DRAINAGE PIPE
- PATHWAY
- EDGE OF PAVEMENT
- BARRIER KERB AND CHANNEL - B1 (IPWEAQ RS-080)
- MOUNTABLE KERB AND CHANNEL - M1 (IPWEAQ RS-080)

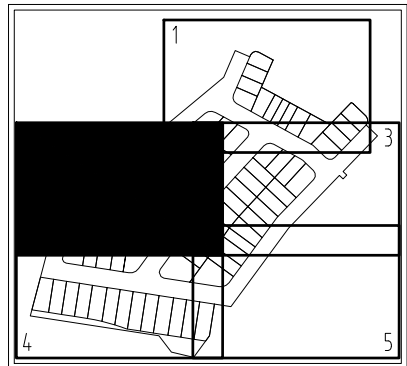

KEYPLAN N.T.S.

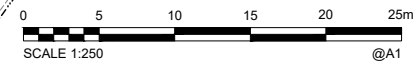
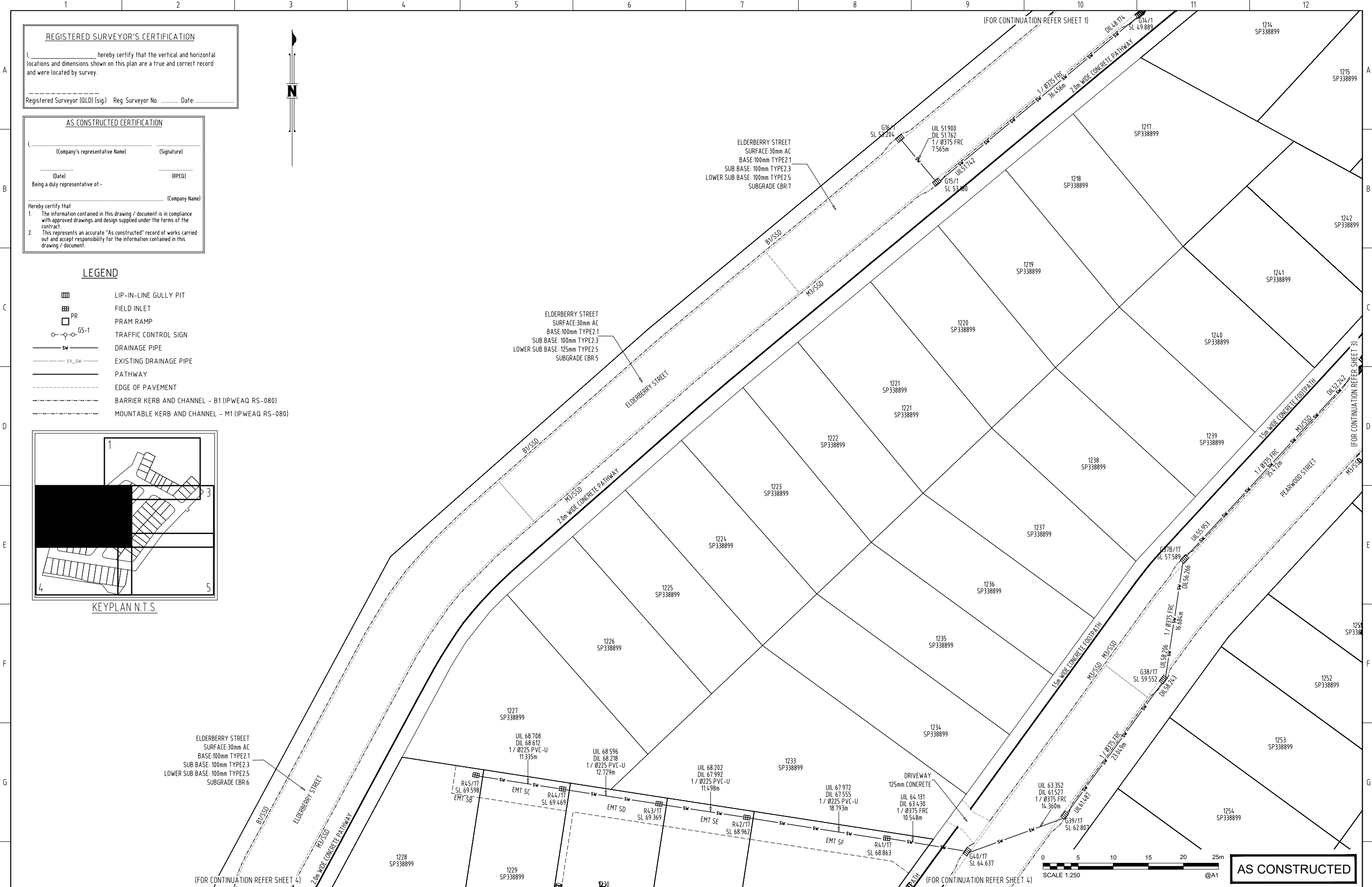

AS CONSTRUCTED

DRAWING REVISIONS		REFERENCE DRAWINGS		DESIGN FILE No.		DESIGNED	
REV.	REVISION DESCRIPTION	DRG. No.	DESCRIPTION	CONSTRUCT. No.	DATE	DRAWN	RMP
0	AS-CONSTRUCTED DRAWINGS						

THIS WORK WAS PREPARED BY:
 Lion Systems on behalf of SHADFORTH

SCALE 1:250 ORIGINAL SIZE A1

MORETON BAY REGIONAL COUNCIL
 PINE DISTRICT OFFICE
 220 GYMPIE ROAD STRATHPINE QLD 4500
 PO BOX 159 CABOOLTURE QLD 4510
 Telephone: (07) 3480 8666
 Fax: (07) 3480 6710

ROADS AND DRAINAGE
AS CONSTRUCTED
RIDGEVIEW - STAGE 12A, 12B, 12C
RAYNBIRD ROAD, NARANGBA

MBRC SUBDIVISION REFERENCE	
DA/2024/2801	
No. 2 OF 5 PLANS	
ASCON GRID NUMBER	REV.
	0

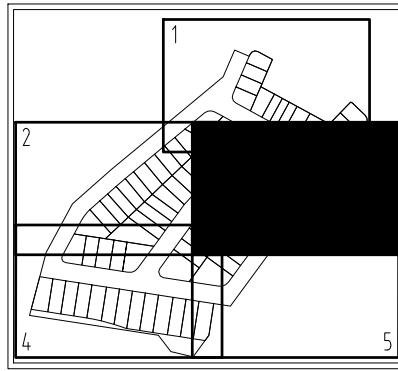
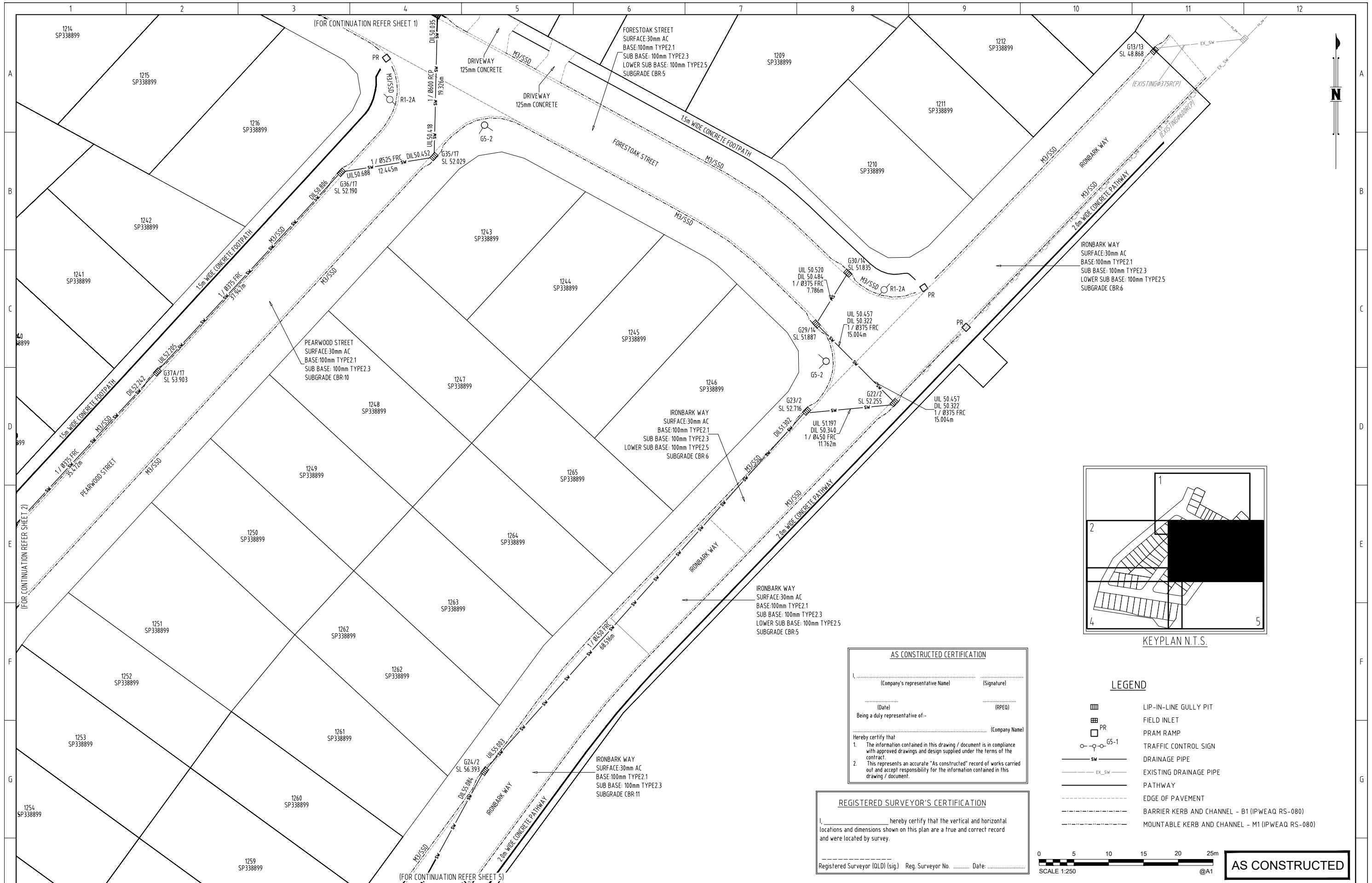

AS CONSTRUCTED CERTIFICATION

I, _____ (Company's representative Name) _____ (Signature)
 _____ (Date) _____ (RPEQ)
 Being a duly representative of: _____ (Company Name)

Hereby certify that:
 1. The information contained in this drawing / document is in compliance with approved drawings and design supplied under the terms of the contract.
 2. This represents an accurate "As constructed" record of works carried out and accept responsibility for the information contained in this drawing / document.

REGISTERED SURVEYOR'S CERTIFICATION

I, _____ hereby certify that the vertical and horizontal locations and dimensions shown on this plan are a true and correct record and were located by survey.

Registered Surveyor (OLD) (sig.) Reg. Surveyor No. _____ Date: _____

LEGEND

- LIP-IN-LINE GULLY PIT
- FIELD INLET
- PRAM RAMP
- TRAFFIC CONTROL SIGN
- DRAINAGE PIPE
- EXISTING DRAINAGE PIPE
- PATHWAY
- EDGE OF PAVEMENT
- BARRIER KERB AND CHANNEL - B1 (IPWEAQ RS-080)
- MOUNTABLE KERB AND CHANNEL - M1 (IPWEAQ RS-080)

0 5 10 15 20 25m
 SCALE 1:250 @A1

AS CONSTRUCTED

DRAWING REVISIONS REV. REVISION DESCRIPTION 0 AS-CONSTRUCTED DRAWINGS		REFERENCE DRAWINGS DRG. No. DESCRIPTION		DESIGN FILE No. CONSTRUCT. No. SURVEY FILE No. FIELD BOOK LOG BOOK LEVEL DATUM DATUM		DESIGNED DATE DRAWN RMP DATE 10/07/2025 CHECKED DL DATE 10/07/2025		THIS WORK WAS PREPARED BY: Lion Systems on behalf of SHADFORTH		 MORETON BAY REGIONAL COUNCIL PINE DISTRICT OFFICE 220 GYMPIE ROAD STRATHPINE QLD 4500 PO BOX 159 CABOOLTURE QLD 4510 Telephone: (07) 3480 8666 Fax: (07) 3480 6710		ROADS AND DRAINAGE AS CONSTRUCTED RIDGEVIEW - STAGE 12A, 12B, 12C RAYNBIRD ROAD, NARANGBA		MBRC SUBDIVISION REFERENCE DA/2024/2801 No. 3 OF 5 PLANS ASCON GRID NUMBER REV. 0	
--	--	---	--	---	--	--	--	--	--	--	--	--	--	--	--



AS CONSTRUCTED CERTIFICATION

I, _____ (Company's representative Name) _____ (Signature)
 _____ (Date) _____ (RPEQ)
 Being a duly representative of- _____ (Company Name)

Hereby certify that
 1. The information contained in this drawing / document is in compliance with approved drawings and design supplied under the terms of the contract.
 2. This represents an accurate "As constructed" record of works carried out and accept responsibility for the information contained in this drawing / document.

REGISTERED SURVEYOR'S CERTIFICATION

I, _____ hereby certify that the vertical and horizontal locations and dimensions shown on this plan are a true and correct record and were located by survey.

Registered Surveyor (QLO) (sig) Reg. Surveyor No. _____ Date: _____

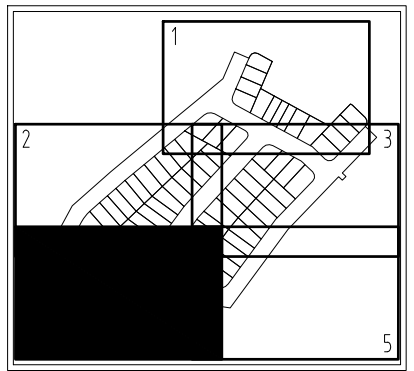

- LEGEND**
- LIP-IN-LINE GULLY PIT
 - FIELD INLET
 - PRAM RAMP
 - TRAFFIC CONTROL SIGN
 - DRAINAGE PIPE
 - EXISTING DRAINAGE PIPE
 - PATHWAY
 - EDGE OF PAVEMENT
 - BARRIER KERB AND CHANNEL - B1 (IPWEAQ RS-080)
 - MOUNTABLE KERB AND CHANNEL - M1 (IPWEAQ RS-080)

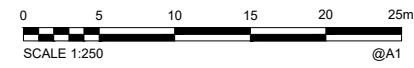

AS CONSTRUCTED

DRAWING REVISIONS		REFERENCE DRAWINGS		DESIGN FILE No.	DESIGNED
REV.	REVISION DESCRIPTION	DRG. No.	DESCRIPTION	CONSTRUCT. No.	DATE
0	AS-CONSTRUCTED DRAWINGS				

DESIGNED	DATE	DESIGNED	DATE
RMP	10/07/2025	DL	10/07/2025

THIS WORK WAS PREPARED BY:

Lion Systems on behalf of SHADFORTH

SCALE 1:250 ORIGINAL SIZE A1



MORETON BAY REGIONAL COUNCIL
 PINE DISTRICT OFFICE
 220 GYMPIE ROAD STRATHPINE QLD 4500
 PO BOX 159 CABOOLTURE QLD 4510
 Telephone: (07) 3480 6666
 Fax: (07) 3480 6710

ROADS AND DRAINAGE
AS CONSTRUCTED
RIDGEVIEW - STAGE 12A, 12B, 12C
RAYNBIRD ROAD, NARANGBA

MBRC SUBDIVISION REFERENCE	
DA/2024/2801	
No. 4 OF 5 PLANS	
ASCON GRID NUMBER	REV.
	0

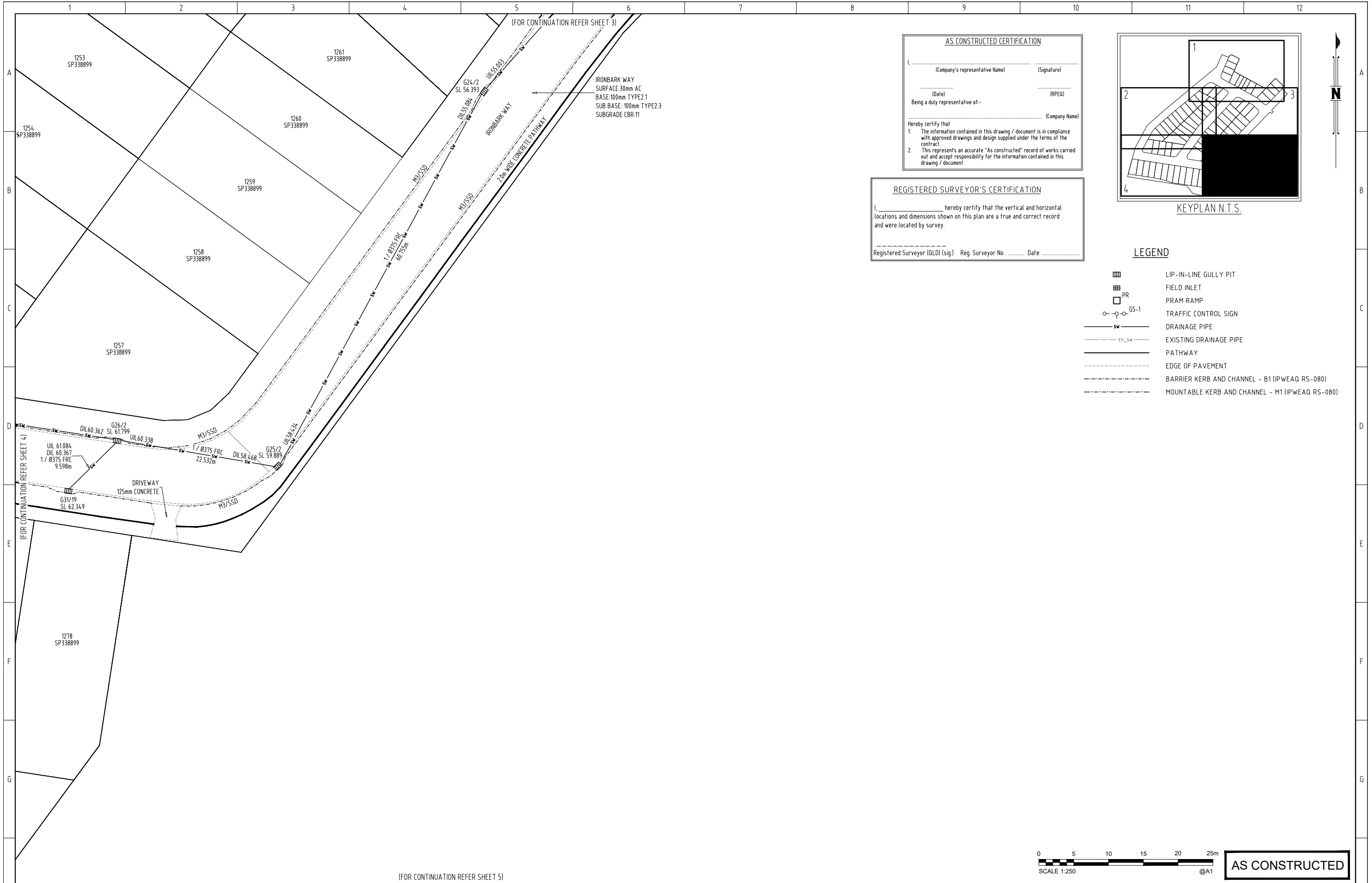

AS CONSTRUCTED CERTIFICATION

I, _____ (Company's representative Name) _____ (Signature)
 _____ (Date) _____ (RPEQ)
 Being a duly representative of:- _____ (Company Name)

Hereby certify that
 1. The information contained in this drawing / document is in compliance with approved drawings and design supplied under the terms of the contract.
 2. This represents an accurate "As constructed" record of works carried out and accept responsibility for the information contained in this drawing / document.

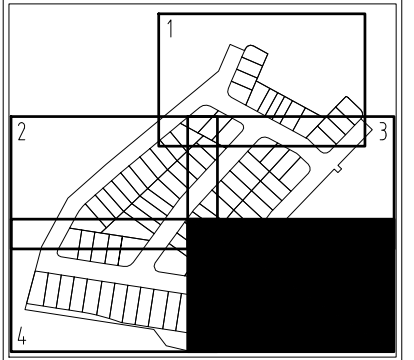

REGISTERED SURVEYOR'S CERTIFICATION

I, _____ hereby certify that the vertical and horizontal locations and dimensions shown on this plan are a true and correct record and were located by survey.

Registered Surveyor (QLD) [sig.] Reg. Surveyor No. _____ Date: _____

- LEGEND**
- LIP-IN-LINE GULLY PIT
 - FIELD INLET
 - PRAM RAMP
 - TRAFFIC CONTROL SIGN G5-1
 - DRAINAGE PIPE SW
 - EXISTING DRAINAGE PIPE EX_SW
 - PATHWAY
 - EDGE OF PAVEMENT
 - BARRIER KERB AND CHANNEL - B1 (IPWEAQ RS-080)
 - MOUNTABLE KERB AND CHANNEL - M1 (IPWEAQ RS-080)

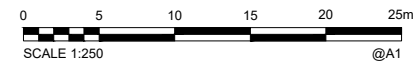

AS CONSTRUCTED

(FOR CONTINUATION REFER SHEET 5)

DRAWING REVISIONS		REFERENCE DRAWINGS		DESIGN FILE No.	DESIGNED
REV.	REVISION DESCRIPTION	DRG. No.	DESCRIPTION	CONSTRUCT. No.	DATE
0	AS-CONSTRUCTED DRAWINGS				

THIS WORK WAS PREPARED BY:

Lion Systems on behalf of SHADFORTH

DESIGNED	DATE	10/07/2025
DRAWN	RMP	
CHECKED	DL	
DATE	10/07/2025	

SCALE 1:250 ORIGINAL SIZE A1



MORETON BAY REGIONAL COUNCIL
 PINE DISTRICT OFFICE
 220 GYMPIE ROAD STRATHPINE QLD 4500
 PO BOX 159 CABOOLTURE QLD 4510
 Telephone: (07) 3480 8666
 Fax: (07) 3480 6710

ROADS AND DRAINAGE
AS CONSTRUCTED
RIDGEVIEW - STAGE 12A, 12B, 12C
RAYNBIRD ROAD, NARANGBA

MBRC SUBDIVISION REFERENCE	
DA/2024/2801	
No. 5 OF 5 PLANS	
ASCON GRID NUMBER	REV.
	0